

# КАТАЛОГ

По вопросам продаж и поддержки обращайтесь:

Алматы (7273)495-231  
Ангарск (3955)60-70-56  
Архангельск (8182)63-90-72  
Астрахань (8512)99-46-04  
Барнаул (3852)73-04-60  
Белгород (4722)40-23-64  
Благовещенск (4162)22-76-07  
Брянск (4832)59-03-52  
Владивосток (423)249-28-31  
Владикавказ (8672)28-90-48  
Владимир (4922)49-43-18  
Волгоград (844)278-03-48  
Вологда (8172)26-4159  
Воронеж (473)204-51-73  
Екатеринбург (343)384-55-89  
Иваново (4932)77-34-06  
Ижевск (3412)26-03-58  
Иркутск (395)279-98-46  
Казань (843)206-01-48

Калининград (4012)72-03-81  
Калуга (4842)92-23-67  
Кемерово (3842)65-04-62  
Киров (8332)68-02-04  
Коломна (4966)23-41-49  
Кострома (4942)77-07-48  
Краснодар (861)203-40-90  
Красноярск (391)204-63-61  
Курск (4712)77-13-04  
Курган (3522)50-90-47  
Липецк (4742)52-20-81  
Магнитогорск (3519)55-03-13  
Москва (495)268-04-70  
Мурманск (8152)59-64-93  
Набережные Челны (8552)20-53-41  
Нижний Новгород (831)429-08-12  
Новокузнецк (3843)20-46-81  
Ноябрьск (3496)41-32-12  
Новосибирск (383)227-86-73

Омск (3812)21-46-40  
Орел (4862)44-53-42  
Оренбург (3532)37-68-04  
Пенза (8412)22-31-16  
Петрозаводск (8142)55-98-37  
Псков (8112)59-10-37  
Пермь (342)205-81-47  
Ростов-на-Дону (863)308-18-15  
Рязань (4912)46-61-64  
Самара (846)206-03-16  
Саранск (8342)22-96-24  
Санкт-Петербург (812)309-46-40  
Саратов (845)249-38-78  
Севастополь (8692)22-31-93  
Симферополь (3652)67-13-56  
Смоленск (4812)29-41-54  
Сочи (862)225-72-31  
Ставрополь (8652)20-65-13  
Сургут (3462)77-98-35

Сыктывкар (8212)25-95-17  
Тамбов (4752)50-40-97  
Тверь (4822)63-31-35  
Тольятти (8482)63-91-07  
Томск (3822)98-41-53  
Тула (4872)33-79-87  
Тюмень (3452)66-21-18  
Ульяновск (8422)24-23-59  
Улан-Удэ (3012)59-97-51  
Уфа (347)229-48-12  
Хабаровск (4212)92-98-04  
Чебоксары (8352)28-53-07  
Челябинск (351)202-03-61  
Череповец (8202)49-02-64  
Чита (3022)38-34-83  
Якутск (4112)23-90-97  
Ярославль (4852)69-52-93

Россия +7(495)268-04-70

Казахстан +7(7172)727-132

Киргизия +996(312)96-26-47

Адрес: <https://walmec.nt-rt.ru/> || эл. почта: [wce@nt-rt.ru](mailto:wce@nt-rt.ru)

# DIECIMILA series

New and performing line of spray guns, replacing the famous 9000 models, its predecessor was one of the greatest in the industry.

Developed following a new concept, air valve and needle on a single axis for more precision, functionality and easy maintenance.

The spray gun body is nickered plated aluminum, lighter for better handling; the air cap is nickered plated brass to guarantee high performance in atomizing and ideal fan.

The 10000 series is available in 3 versions:

- HVLP as from norm n. 1151 SCAQMD, 0.7 bar pressure at the air cap and over 65% transfer efficiency.

Low air consumption 230 l/min, LV system (low volume) it makes it a very efficient tool, able to perform even with smaller compressors.

- HTE the new and high transfer efficiency system (>65%), an excellent atomizing quality by the 1.3 bar air cap pressure

- HTE SR the same HTE features but without the air gage regulator.

In this section you can find also the special application spray guns line: GEL COAT - ECOMIX - GLU - HIGH DENSITY (still on the 9000 series spray gun body) able to offer ideal solutions for industrial and shipyard application.

**GEL COAT**  
"Super GT" nozzle and air cap specific for Gel Coat and dense production application.

**9011 GEL COAT**  
Ref. 255

**HD**  
Pressurised cup for dense product application in general and especially for tixotropic paints for the woodworks sector.

**9011 HD**  
Ref. 233

**ECOMIX**  
Regulator for better pressure dosage in the mural product application phase.

**9010 ECOMIX**  
Ref. 250

**9010/SP COLLA**  
Ref. 253

**GLUE**  
Reinforced spring for better hold in glue application in the furniture manufacturing sector.

**10011 HVLP**  
Ref. 480



## PACKAGING

All spray guns of the Diecimila series are supplied in handy rigid plastic suitcases containing all the accessories for a correct cleaning and maintenance.

**10011 HVLP** (with 680 cc nylon cup) - Ref. 480\*\*

Body: chemical nickel-plated polished aluminium  
 Air cap: chemical nickel-plated brass  
 Nozzle: AISI 303 stainless steel  
 Needle-spring: stainless steel  
 Weight: 935 g

Operating air pressure: 2.0 bar  
 Air consumption: 230 l/min.  
 Ø nozzle: 1.3 - 1.5 - 1.7 - 1.9 - 2.2

**Air inlet pressure regulator with pressure gauge**

500 cc aluminium cup version (Weight: 835 g)	Ref. 481**
750 cc aluminium cup version (Weight: 880 g)	Ref. 482**



NOTE:  
add nozzle Ø to Ref. (\*\*)

Recommended use:



**10010 HVLP** Ref. 485\*\*

Camlock suction cup: aluminium 1000 cc  
 Body: chemical nickel-plated polished aluminium  
 Air cap: chemical nickel-plated brass  
 Nozzle: AISI 303 stainless steel  
 Needle-spring: stainless steel  
 Weight: 1.15 Kg

Operating air pressure: 2.0 bar  
 Air consumption: 230 l/min.  
 Ø nozzle: 1.7 - 1.9 - 2.2

**Air inlet pressure regulator with pressure gauge**



NOTE:  
add nozzle Ø to Ref. (\*\*)

Recommended use:



**10010 HVLP** Ref. 486\*\*

Bayonet suction cup: aluminium 1000 cc  
 Body: chemical nickel-plated polished aluminium  
 Air cap: chemical nickel-plated brass  
 Nozzle: AISI 303 stainless steel  
 Needle-spring: stainless steel  
 Weight: 1.13 Kg

Operating air pressure: 2.0 bar  
 Air consumption: 230 l/min.  
 Ø nozzle: 1.7 - 1.9 - 2.2

**Air inlet pressure regulator with pressure gauge**



NOTE:  
add nozzle Ø to Ref. (\*\*)

Recommended use:



**10010/SP HVLP** Ref. 487\*\*

To be used through pressurized containers, low pressure pumps product inlet M1/4"  
 Body: chemical nickel-plated polished aluminium  
 Air cap: chemical nickel-plated brass  
 Nozzle: AISI 303 stainless steel  
 Needle-spring: stainless steel  
 Weight: 750 g

Operating air pressure: 2.0 bar  
 Air consumption: 230 l/min.  
 Ø nozzle: 1.0 - 1.3 - 1.5 - 1.7 - 1.9 - 2.2

**Air inlet pressure regulator with pressure gauge**



NOTE:  
add nozzle Ø to Ref. (\*\*)

Recommended use:



**10011 HTE** (with 680 cc nylon cup) - Ref. 489\*\*

Body: chemical nickel-plated polished aluminium  
 Air cap: chemical nickel-plated brass  
 Nozzle: AISI 303 stainless steel  
 Needle-spring: stainless steel  
 Weight: 935 g

Operating air pressure: 2.0 - 2.5 bar  
 Air consumption: 220 - 260 l/min.  
 Ø nozzle: 1.0 - 1.2 - 1.3 - 1.5 - 1.7 - 1.9 - 2.2 - 2.5

**Air inlet pressure regulator with pressure gauge**

500 cc aluminium cup version (Weight: 670 g)	Ref. 493**
750 cc aluminium cup version (Weight: 720 g)	Ref. 488**



NOTE:  
add nozzle Ø to Ref. (\*\*)

Recommended use:



**10010 HTE** Ref. 484\*\*

Camlock suction cup: aluminium 1000 cc  
 Body: chemical nickel-plated polished aluminium  
 Air cap: chemical nickel-plated brass  
 Nozzle: AISI 303 stainless steel  
 Needle-spring: stainless steel  
 Weight: 1.15 Kg

Operating air pressure: 2.0 - 2.5 bar  
 Air consumption: 220 - 260 l/min.  
 Ø nozzle: 1.0 - 1.2 - 1.3 - 1.5 - 1.7 - 1.9 - 2.2 - 2.5

**Air inlet pressure regulator with pressure gauge**



NOTE:  
add nozzle Ø to Ref. (\*\*)

Recommended use:



**10010 HTE** Ref. 494\*\*

Bayonet suction cup: aluminium 1000 cc  
 Body: chemical nickel-plated polished aluminium  
 Air cap: chemical nickel-plated brass  
 Nozzle: AISI 303 stainless steel  
 Needle-spring: stainless steel  
 Weight: 1.13 Kg

Operating air pressure: 2.0 - 2.5 bar  
 Air consumption: 220 - 260 l/min.  
 Ø nozzle: 1.0 - 1.2 - 1.3 - 1.5 - 1.7 - 1.9 - 2.2 - 2.5

**Air inlet pressure regulator with pressure gauge**



NOTE:  
add nozzle Ø to Ref. (\*\*)

Recommended use:



**10010/SP HTE** Ref. 483\*\*

To be used through pressurized containers, low pressure pumps product inlet M1/4"  
 Body: chemical nickel-plated polished aluminium  
 Air cap: chemical nickel-plated brass  
 Nozzle: AISI 303 stainless steel  
 Needle-spring: stainless steel  
 Weight: 750 g

Operating air pressure: 2.0 - 2.5 bar  
 Air consumption: 220 - 260 l/min.  
 Ø nozzle: 1.0 - 1.2 - 1.3 - 1.5 - 1.7 - 1.9 - 2.2

**Air inlet pressure regulator with pressure gauge**



NOTE:  
add nozzle Ø to Ref. (\*\*)

Recommended use:



**10011 HTE SR** (with 680 cc nylon cup) - Ref. 490\*\*

Body: chemical nickel-plated polished aluminium  
 Air cap: chemical nickel-plated brass  
 Nozzle: AISI 303 stainless steel  
 Needle-spring: stainless steel  
 Weight: 785 g

Operating air pressure: 2.0 - 2.5 bar  
 Air consumption: 220 - 260 l/min.  
 Ø nozzle: 1.0 - 1.2 - 1.3 - 1.5 - 1.7 - 1.9 - 2.2 - 2.5

500 cc aluminium cup version (Weight: 670 g)	Ref. 491**
750 cc aluminium cup version (Weight: 720 g)	Ref. 492**



NOTE:  
add nozzle Ø to Ref. (\*\*)

Recommended use:



**10010 HTE SR** Ref. 495\*\*

Camlock suction cup: aluminium 1000 cc  
 Body: chemical nickel-plated polished aluminium  
 Air cap: chemical nickel-plated brass  
 Nozzle: AISI 303 stainless steel  
 Needle-spring: stainless steel  
 Weight: 980 g

Operating air pressure: 2.0 - 2.5 bar  
 Air consumption: 220 - 260 l/min.  
 Ø nozzle: 1.0 - 1.2 - 1.3 - 1.5 - 1.7 - 1.9 - 2.2 - 2.5



NOTE:  
add nozzle Ø to Ref. (\*\*)

Recommended use:



**10010 HTE SR** Ref. 496\*\*

Bayonet suction cup: aluminium 1000 cc  
 Body: chemical nickel-plated polished aluminium  
 Air cap: chemical nickel-plated brass  
 Nozzle: AISI 303 stainless steel  
 Needle-spring: stainless steel  
 Weight: 970 g

Operating air pressure: 2.0 - 2.5 bar  
 Air consumption: 220 - 260 l/min.  
 Ø nozzle: 1.0 - 1.2 - 1.3 - 1.5 - 1.7 - 1.9 - 2.2 - 2.5



NOTE:  
add nozzle Ø to Ref. (\*\*)

Recommended use:



**10010/SP HTE SR** Ref. 497\*\*

To be used through pressurized containers, low pressure pumps product inlet M1/4"  
 Body: chemical nickel-plated polished aluminium  
 Air cap: chemical nickel-plated brass  
 Nozzle: AISI 303 stainless steel  
 Needle-spring: stainless steel  
 Weight: 600 g

Operating air pressure: 2.0 - 2.5 bar  
 Air consumption: 220 - 260 l/min.  
 Ø nozzle: 1.0 - 1.2 - 1.3 - 1.5 - 1.7 - 1.9 - 2.2



NOTE:  
add nozzle Ø to Ref. (\*\*)

Recommended use:



## 10011 HVLP HD

Ref. 498\*\*

## 10011 HTE HD

Ref. 499\*\*

Pressurised gravity cup (M 1/4" product inlet): for high density products such as latex, polyurethane, gel coat, tixotropic products in the wood and industrial sectors.

Body: chemically nickel plated polished aluminium

Nozzle: AISI 303 stainless steel

Air cap: chemically nickeled brass

Needle-spring: stainless steel

Weight: 1.25 Kg

Operating air pressure: 2.0 - 2.5 bar

Air consumption: 200 - 240 l/min. for HVLP - 240 - 280 l/min. for HTE

Ø nozzle: 1.3 - 1.5 - 1.7 - 1.9 - 2.2

**Double spray gun air inlet pressure regulator and pressurised cup with pressure gauge**



NOTE:  
add nozzle Ø to Ref. (\*\*)

Recommended use:



## 9010 ECOMIX

Adjustable suction pressure bayonet cup:

1000 cc stainless steel

Ref. 250\*\*

## 9010/SP ECOMIX

To be used through pressurized containers, low pressure pumps - Product inlet M1/4"

Ref. 251\*\*

Body: chemically nickel plated polished aluminium

Air cap: chemically nickeled brass

Needle-nozzle-springs: stainless steel

Adjustments: air-product-fan

Cup gasket: o-ring in EPDM - (only version Ref. 250\*\*)

Use: application of wall paints in the building sector

Weight: 940 g Ecomix - 610 g Ecomix SP

Operating air pressure: 2.5 - 3.0 bar

Air consumption: 200 - 240 l/min.

Ø nozzle: 2.2 - 2.5 - 3.0

**Equipped with regulator group of the air inlet flow and air pressure to the cup - vers. Ref. 250\*\***



NOTE:  
add nozzle Ø to Ref. (\*\*)

Recommended use:



## 9011 GEL COAT

Cup: nylon 680 cc

Ref. 255\*\*

## 9010/SP GEL COAT

To be used through pressurized containers, low pressure pumps - Product inlet M1/4"

Ref. 256\*\*

Body: chemical nickel-plated polished aluminium

Air cap: chemical nickel-plated brass

Needle-spring-nozzle: stainless steel

Adjustments: air-product-fan

Use: for application of Gel Coat and dense products generally

Weight: 810 g Gel Coat - 590 g Gel Coat SP

Operating air pressure: 2.0 - 3.0 bar

Air consumption: 180 - 240 l/min.

Ø nozzle: 3.0 - 4.0 - 5.0



NOTE:  
add nozzle Ø to Ref. (\*\*)

Recommended use:



## 9010/SP COLLA

Ref. 253\*\*

To be used through pressurized containers, low pressure pumps - Product inlet M1/4"

Body: chemically nickel plated polished aluminium

Air cap: chemically nickeled brass

Needle-nozzle-springs: stainless steel

Adjustments: product-fan

Weight: 590 g

Operating air pressure: 2.5 - 3.0 bar

Air consumption: 180 - 240 l/min.

Ø nozzle: 1.7 - 1.9



NOTE:  
add nozzle Ø to Ref. (\*\*)

Recommended use:



# SEIMILA series

The new line of high performance spray guns in terms of both fan and atomization and durability and reliability. Manufactured with all of Asturomec®'s experience as a guarantee, they are the maximum expression of an ideal spray gun for all sectors that require quality paint results associated with efficiency.

From bodyworks to woodworks, industry and crafts, the new SEIMILA series was specifically designed to fully enhance the operator's work.

Available in the HVLP version (0.7 bar at air cap; transfer efficiency > 65%) and HTE version, this spray gun comes with a highly pulverising HT air cap and is built to resist aggression from all types of solvents.

The lack of gaskets, thanks to high precision mechanical processing, guarantees that highly desired durability appreciated by operators in the various reference sectors.

**HT AIR CAP**  
Highly pulverising air cap, it guarantees high paint performance and low product consumption.

**BODY**  
Polished and treated die-cast aluminium to guarantee the utmost precision, resistance, ergonomics and durability.

**LEVER**  
Made of nickel-plated steel, ergonomic and with the right size for accurate air and product dosage.

**ADJUSTMENTS**  
Accurate and reliable, they are a key element for a leading spray gun in all paint sectors.

**6011 HVLP**  
Ref. 460



**6011 HVLP** (with 680 cc nylon cup) - Ref. 460\*\*

Body: polished and treated aluminium  
 HT Air cap: nickel-plated brass  
 Needle-spring-nozzle: stainless steel  
 Adjustments: product-fan  
 Weight: 755 g

Operating air pressure: 2.5 - 3.0 bar  
 Air consumption: 180 - 220 l/min.  
 Ø nozzle: 1.2 - 1.4 - 1.7 - 1.9 - 2.2 - 2.5 - 3.0

500 cc aluminium cup version	(Weight: 670 g)	Ref. 461**
750 cc aluminium cup version	(Weight: 720 g)	Ref. 462**



NOTE:  
 add nozzle Ø to Ref. (\*\*)

Recommended use:



**6010 HVLP** Ref. 465\*\*

Camlock suction cup: aluminium 1000 cc  
 Body: polished and treated aluminium  
 HT Air cap: nickel-plated brass  
 Needle-spring-nozzle: stainless steel  
 Adjustments: product-fan  
 Weight: 990 g

Operating air pressure: 2.5 - 3.0 bar  
 Air consumption: 220 - 240 l/min.  
 Ø nozzle: 1.2 - 1.4 - 1.7 - 1.9 - 2.2 - 2.5 - 3.0



NOTE:  
 add nozzle Ø to Ref. (\*\*)

Recommended use:



**6010 HVLP** Ref. 466\*\*

Bayonet suction cup: aluminium 1000 cc  
 Body: polished and treated aluminium  
 HT Air cap: nickel-plated brass  
 Needle-spring-nozzle: stainless steel  
 Adjustments: product-fan  
 Weight: 920 g

Operating air pressure: 2.5 - 3.0 bar  
 Air consumption: 220 - 240 l/min.  
 Ø nozzle: 1.2 - 1.4 - 1.7 - 1.9 - 2.2 - 2.5 - 3.0



NOTE:  
 add nozzle Ø to Ref. (\*\*)

Recommended use:



**6010/SP HVLP** Ref. 467\*\*

To be used through pressurized containers, low pressure pumps - Product inlet M1/4"  
 Body: polished and treated aluminium  
 HT Air cap: nickel-plated brass  
 Needle-spring-nozzle: stainless steel  
 Adjustments: product-fan  
 Weight: 590 g

Operating air pressure: 2.5 - 3.0 bar  
 Air consumption: 220 - 240 l/min.  
 Ø nozzle: 1.2 - 1.4 - 1.7 - 1.9 - 2.2 - 2.5 - 3.0



NOTE:  
 add nozzle Ø to Ref. (\*\*)

Recommended use:





**6011 HTE** (with 680 cc nylon cup) - Ref. 470\*\*

Body: polished and treated aluminium  
 HT Air cap: nickel-plated brass  
 Needle-spring-nozzle: stainless steel  
 Adjustments: product-fan  
 Weight: 755 g

Operating air pressure: 2.5 - 3.0 bar  
 Air consumption: 180 - 220 l/min.  
 Ø nozzle: 1.2 - 1.4 - 1.7 - 1.9 - 2.2 - 2.5 - 3.0

500 cc aluminium cup version	(Weight: 670 g)	Ref. 471**
750 cc aluminium cup version	(Weight: 720 g)	Ref. 472**



NOTE:  
 add nozzle Ø to Ref. (\*\*)

Recommended use:



**6010 HTE** Ref. 475\*\*

Camlock suction cup: aluminium 1000 cc  
 Body: polished and treated aluminium  
 HT Air cap: nickel-plated brass  
 Needle-spring-nozzle: stainless steel  
 Adjustments: product-fan  
 Weight: 990 g

Operating air pressure: 2.5 - 3.0 bar  
 Air consumption: 220 - 240 l/min.  
 Ø nozzle: 1.2 - 1.4 - 1.7 - 1.9 - 2.2 - 2.5 - 3.0



NOTE:  
 add nozzle Ø to Ref. (\*\*)

Recommended use:



**6010 HTE** Ref. 476\*\*

Bayonet suction cup: aluminium 1000 cc  
 Body: polished and treated aluminium  
 HT Air cap: nickel-plated brass  
 Needle-spring-nozzle: stainless steel  
 Adjustments: product-fan  
 Weight: 920 g

Operating air pressure: 2.5 - 3.0 bar  
 Air consumption: 220 - 240 l/min.  
 Ø nozzle: 1.2 - 1.4 - 1.7 - 1.9 - 2.2 - 2.5 - 3.0



NOTE:  
 add nozzle Ø to Ref. (\*\*)

Recommended use:



**6010/SP HTE** Ref. 477\*\*

To be used through pressurized containers, low pressure pumps - Product inlet M1/4"  
 Body: polished and treated aluminium  
 HT Air cap: nickel-plated brass  
 Needle-spring-nozzle: stainless steel  
 Adjustments: product-fan  
 Weight: 590 g

Operating air pressure: 2.5 - 3.0 bar  
 Air consumption: 220 - 240 l/min.  
 Ø nozzle: 1.2 - 1.4 - 1.7 - 1.9 - 2.2 - 2.5 - 3.0



NOTE:  
 add nozzle Ø to Ref. (\*\*)

Recommended use:



# OM-IM-UR PLUS series

Spray guns designed to combine reliability, versatility and price. Their strength has made them the market leaders since their launch in the 50s. But the strength of a product can be seen by the way it develops, so, in 1999, the HVLP version of the OM was created to meet the needs of the most sensitive markets in terms of product saving and environmental regulations.

The professional IM/OM version originated the creation of the UR PLUS version, with brass components which, considering the quality/price ratio, makes the product also suitable for D.I.Y.

**UR PLUS  
UR/S PLUS**  
Brass needle and nozzle, improved quality/price ratio without compromising reliability and performance.

**UR/S PLUS**  
Ref. 273

**IM - OM**  
CNC processed single-body brass, for years a guarantee for durability, resilience and performance. In short, IM-OM.

**IM**  
Ref. 262

**OM**  
Ref. 263

**OM GREEN**  
Ref. 290

**OM GREEN**  
Green grip to demonstrate ecology, paint product saving but with Astuomec® IM-OM quality.

**OM GREEN** (with 680 cc nylon cup) - Ref. 290\*\*

Body: nickel-plated sanded brass  
 Air cap: nickel-plated brass  
 Needle-nozzle-springs: stainless steel  
 Adjustments: product-fan  
 Weight: 780 g

Operating air pressure: 2.0 bar  
 Air consumption: 200 l/min.  
 Ø nozzle: 1.4 - 1.7 - 1.9 - 2.2

**HVLP system: low overspray, significant paint product savings**

250 cc nylon cup version	(Weight: 670 g)	Ref. 291**
500 cc aluminium cup version	(Weight: 680 g)	Ref. 292**
750 cc aluminium cup version	(Weight: 730 g)	Ref. 293**



NOTE:  
add nozzle Ø to Ref. (\*\*)

Recommended use:



**IM GREEN** Ref. 307\*\*

Camlock suction cup: aluminium 1000 cc  
 Body: nickel-plated sanded brass  
 Air cap: nickel-plated brass  
 Needle-nozzle-springs: stainless steel  
 Adjustments: product-fan  
 Weight: 1.01 Kg

Operating air pressure: 2.0 bar  
 Air consumption: 200 l/min.  
 Ø nozzle: 1.4 - 1.7 - 1.9 - 2.2

**HVLP system: low overspray, significant paint product savings**



NOTE:  
add nozzle Ø to Ref. (\*\*)

Recommended use:



**IM GREEN** Ref. 308\*\*

Bayonet suction cup: aluminium 1000 cc  
 Body: nickel-plated sanded brass  
 Air cap: nickel-plated brass  
 Needle-nozzle-springs: stainless steel  
 Adjustments: product-fan  
 Weight: 950 g

Operating air pressure: 2.0 bar  
 Air consumption: 200 l/min.  
 Ø nozzle: 1.4 - 1.7 - 1.9 - 2.2

**HVLP system: low overspray, significant paint product savings**



NOTE:  
add nozzle Ø to Ref. (\*\*)

Recommended use:



**IM/SP GREEN** Ref. 309\*\*

To be used through pressurized containers, low pressure pumps - Product inlet M1/4"  
 Body: nickel-plated sanded brass  
 Air cap: nickel-plated brass  
 Needle-nozzle-springs: stainless steel  
 Adjustments: product-fan  
 Weight: 620 g

Operating air pressure: 2.0 bar  
 Air consumption: 200 l/min.  
 Ø nozzle: 1.4 - 1.7 - 1.9 - 2.2

**HVLP system: low overspray significant paint product savings**



NOTE:  
add nozzle Ø to Ref. (\*\*)

Recommended use:



**OM** (with 680 cc nylon cup) - Ref. 263\*\*

Body: nickel-plated sanded brass  
 Air cap: nickel-plated brass  
 Needle-nozzle-springs: stainless steel  
 Adjustments: product-fan  
 Weight: 780 g

Operating air pressure: 3.0 - 3.5 bar  
 Air consumption: 220 l/min.  
 Ø nozzle: 1.0 - 1.2 - 1.4 - 1.7 - 1.9 - 2.2 - 2.5 - 3.0 - 3.5 - 4.0

250 cc nylon cup version	(Weight: 670 g)	Ref. 264**
500 cc aluminium cup version	(Weight: 680 g)	Ref. 266**
750 cc aluminium cup version	(Weight: 730 g)	Ref. 265**



NOTE:  
add nozzle Ø to Ref. (\*\*)

Recommended use:



**IM** Ref. 262\*\*

Camlock suction cup: aluminium 1000 cc  
 Body: nickel-plated sanded brass  
 Air cap: nickel-plated brass  
 Needle-nozzle-springs: stainless steel  
 Adjustments: product-fan  
 Weight: 1.01 Kg

Operating air pressure: 3.0 - 3.5 bar  
 Air consumption: 200 - 350 l/min.  
 Ø nozzle: 1.2 - 1.4 - 1.7 - 1.9 - 2.2 - 2.5 - 3.0



NOTE:  
add nozzle Ø to Ref. (\*\*)

Recommended use:



**IM** Ref. 260\*\*

Bayonet suction cup: aluminium 1000 cc  
 Body: nickel-plated sanded brass  
 Air cap: nickel-plated brass  
 Needle-nozzle-springs: stainless steel  
 Adjustments: product-fan  
 Weight: 950 g

Operating air pressure: 3.0 - 3.5 bar  
 Air consumption: 200 - 350 l/min.  
 Ø nozzle: 1.2 - 1.4 - 1.7 - 1.9 - 2.2 - 2.5 - 3.0



NOTE:  
add nozzle Ø to Ref. (\*\*)

Recommended use:



**IM/SP** Ref. 269\*\*

To be used through pressurized containers, low pressure pumps - Product inlet M1/4"  
 Body: nickel-plated sanded brass  
 Air cap: nickel-plated brass  
 Needle-nozzle-springs: stainless steel  
 Adjustments: product-fan  
 Weight: 620 g

Operating air pressure: 3.0 - 3.5 bar  
 Air consumption: 200 - 350 l/min.  
 Ø nozzle: 1.2 - 1.4 - 1.7 - 1.9 - 2.2 - 2.5 - 3.0



NOTE:  
add nozzle Ø to Ref. (\*\*)

Recommended use:



**UR/S PLUS** (with 680 cc nylon cup) - Ref. 273\*\*

Body: nickel-plated sanded brass  
 Air cap: nickel-plated brass  
 Needle-nozzle: brass  
 Adjustments: product-fan  
 Weight: 795 g

Operating air pressure: 3.0 - 3.5 bar  
 Air consumption: 200 - 350 l/min.  
 Ø nozzle: 1.2 - 1.4 - 1.7 - 1.8 - 1.9 - 2.2 - 2.5 - 3.0

250 cc nylon cup version	(Weight: 670 g)	Ref. 274**
500 cc aluminium cup version	(Weight: 680 g)	Ref. 276**
750 cc aluminium cup version	(Weight: 730 g)	Ref. 275**



NOTE:  
 add nozzle Ø to Ref. (\*\*)

Recommended use:



**UR PLUS** Ref. 272\*\*

Camlock suction cup: aluminium 1000 cc  
 Body: nickel-plated sanded brass  
 Air cap: nickel-plated brass  
 Needle-nozzle: brass  
 Adjustments: product-fan  
 Weight: 1.01 Kg

Operating air pressure: 3.0 - 3.5 bar  
 Air consumption: 200 - 350 l/min.  
 Ø nozzle: 1.2 - 1.4 - 1.7 - 1.8 - 1.9 - 2.2 - 2.5 - 3.0



NOTE:  
 add nozzle Ø to Ref. (\*\*)



**UR PLUS** Ref. 270\*\*

Bayonet suction cup: aluminium 1000 cc  
 Body: nickel-plated sanded brass  
 Air cap: nickel-plated brass  
 Needle-nozzle: brass  
 Adjustments: product-fan  
 Weight: 950 g

Operating air pressure: 3.0 - 3.5 bar  
 Air consumption: 200 - 350 l/min.  
 Ø nozzle: 1.2 - 1.4 - 1.7 - 1.8 - 1.9 - 2.2 - 2.5 - 3.0



NOTE:  
 add nozzle Ø to Ref. (\*\*)

Recommended use:



**UR PLUS/SP** Ref. 279\*\*

To be used through pressurized containers, low pressure pumps - Product inlet M1/4"  
 Body: nickel-plated sanded brass  
 Air cap: nickel-plated brass  
 Needle-nozzle-springs: stainless steel  
 Adjustments: product-fan  
 Weight: 620 g

Operating air pressure: 3.0 - 3.5 bar  
 Air consumption: 200 - 350 l/min.  
 Ø nozzle: 1.2 - 1.4 - 1.7 - 1.9 - 2.2 - 2.5 - 3.0



NOTE:  
 add nozzle Ø to Ref. (\*\*)

Recommended use:



# GRAPHIC series

Mini high-precision professional spray guns for applications on small surfaces.

The easy application and lightness of these spray guns make them ideal, besides for the industry also for body shops, woodworking.

Thanks to the high quality level this spray gun is also suitable for professional decorators and D.I.Y.

Available with a number of different sized cups according to the specific application.

The new RE version was designed to meet the ever-growing demands of the DIY market, combining the advantages of a quality mini spray gun with an undoubtedly competitive price.

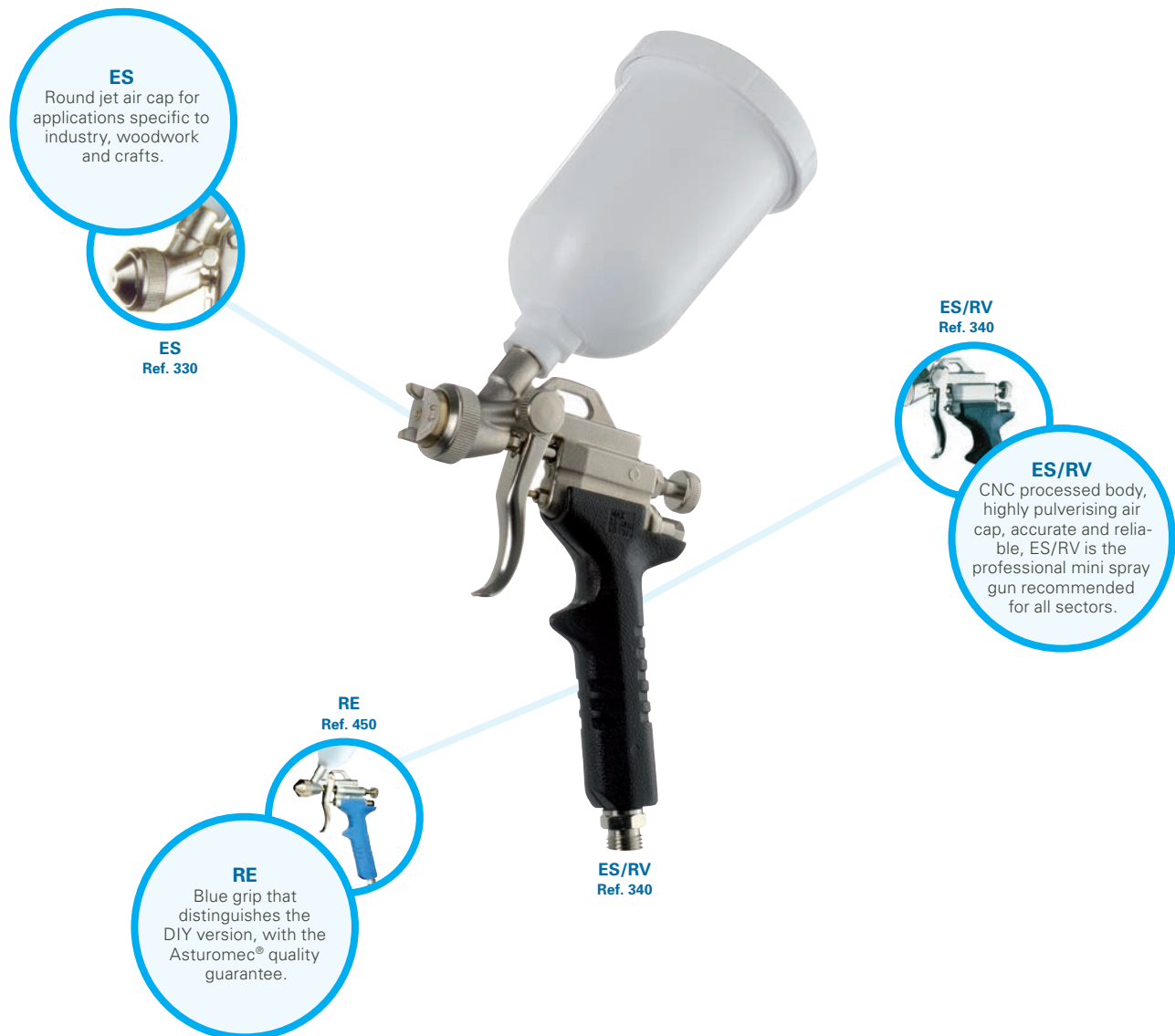

## PACKAGING

Packaging designed to contain a complete set for the decorator. Available in a handy rigid plastic suitcase which allows an ideal set-up of the equipment.

**ES/RV** (with 250 cc nylon cup) - Ref. 340\*\*

Body: nickel-plated sanded brass  
 Air cap: nickel-plated brass  
 Needle-nozzle-springs: stainless steel  
 Adjustments: product-fan  
 Weight: 475 g

Operating air pressure: 1.0 - 3.5 bar  
 Air consumption: 30 - 60 l/min.  
 Ø nozzle: 0.5 - 0.7 - 1.0 - 1.2

75 cc nylon cup version	(Weight: 410 g)	Ref. 341**
125 cc aluminium cup version	(Weight: 425 g)	Ref. 343**



NOTE:  
 add nozzle Ø to Ref. (\*\*)

Recommended use:



**ES** (with 250 cc nylon cup) - Ref. 330\*\*

Body: nickel-plated sanded brass  
 Air cap: nickel-plated brass  
 Needle-nozzle-springs: stainless steel  
 Adjustments: product  
 Weight: 465 g

Operating air pressure: 1.0 - 3.5 bar  
 Air consumption: 30 - 60 l/min  
 Ø nozzle: 0.3 - 0.5 - 0.7 - 1.0

75 cc nylon cup version	(Weight: 400 g)	Ref. 331**
125 cc aluminium cup version	(Weight: 415 g)	Ref. 333**

Versions with 0.3 nozzle Ø



NOTE:  
 add nozzle Ø to Ref. (\*\*)

Recommended use:



**RE** (with 250 cc nylon cup) - Ref. 450\*\*

Body: sanded and galvanised Zama  
 Air cap: nickel-plated brass  
 Needle-springs: stainless steel  
 Adjustments: product  
 Weight: 360 g

Operating air pressure: 1.0 - 3.5 bar  
 Air consumption: 30 - 60 l/min  
 Ø nozzle: 0.3 - 0.5 - 0.7 - 1.0 - 1.2

75 cc nylon cup version	(Weight: 300 g)	Ref. 451**
125 cc aluminium cup version	(Weight: 320 g)	Ref. 452**

Versions with 0.3 nozzle Ø



NOTE:  
 add nozzle Ø to Ref. (\*\*)

Recommended use:



**DECOR BAG** Ref. 39000

Kit for the professional decorator packed in suitcase.  
 Featuring:  
 1 airbrush GRAPHIQUE  
 1 spray gun ES/RV Ø 0.5 with gravity nylon cup, capacity 75 cc  
 1 needle - nozzle - air cap kit Ø 0.3  
 1 DECOR KIT  
 1 air hose Ø 4x6, m 1.5 with fittings

Weight: 1.63 Kg  
 Solid suitcase



NOTE:  
 add nozzle Ø to Ref. (\*\*)



## GRAPHIQUE

Ref. 39003

Professional double action airbrush for airwork and decorating.  
 Body: nickel-plated brass  
 Nozzle: stainless steel  
 Needle-springs-paint passage: stainless steel  
 Double cup: gravity cup in anodized aluminium capacity 4 cc  
 suction cup in glass, capacity 20 cc  
 Featuring: fitting for hose Ø 4x6- service spanner - support

Weight: 300 g  
 Operating air pressure: 0.5-3.5 bar  
 Air consumption: 10-25 l/min.



Recommended use:



## DECOR KIT

Ref. 34500

Ideal for the simultaneous use of more than one product with spray gun EGO HVLP and GRAPHIQUE spray guns.  
 Featuring: 5 glass cups, capacity 20 cc  
 unscrewable adaptor for EGO HVLP

Weight: 210 g



In order to clean your spray gun more rapidly, we suggest that you reserve a cup for the diluent.



Recommended use:





# SPECIAL series

**G1 SERIES:** Spray guns indicated for the application of high density products to obtain a high finish orange peel or sponge effect.

Recommended in all those sectors where a normal spray guns does not provide sufficient yield in spraying these products.

The stainless steel cup and NBR gaskets features make this product resistant to the most aggressive solvents and most improper maintenance.

The new regulator also guarantees constant cup pressure.

**RD SERIES:** Spray gun specific for the application of paint or rust-proofing products on hard to reach areas (such as radiators).

**EPD SERIES:** Pressurised air brush for dense products without atomisation air.

Ideal for glue, sealing and lubricants.

The special "flat or long spout" rods permit precise and efficient applications according to specific needs.

**MM:** Spray gun specific for plastic wall application.

**G1/T**  
The G1 version with round jet, to meet every professional's specific needs.

**G1/T**  
Ref. 362

**G1**  
Accurate body and component processing, pressurised stainless steel cup, flow and pressure regulator, a truly "special" spray gun for over 50 years.

**G1**  
Ref. 361

**EPD**  
Ref. 36700 EPD

**EPD**  
A further demonstration of how Asturomec® is always attentive to market needs, even for specific applications, but with high professional content.

**G1**  
Ref. 361

**RD**  
Ref. 36617

**RD**  
It's adjustable 30 cm air cap has made it indispensable and peerless in certain professional processes.

**G1**

Ref. 361\*\*

Adjustable suction pressure bayonet cup: 1000 cc stainless steel  
 Body: nickel-plated sanded brass  
 Air cap: nickel-plated brass  
 Needle-nozzle-springs: stainless steel  
 Adjustments: product-fan  
 Cup gasket: o-ring in NBR  
 Equipped with regulator group of the air inlet and air pressure to the cup  
 Weight: 1.7 Kg

Operating air pressure: MAX 3.0 bar  
 Air consumption: 370 l/min.  
 Ø nozzle: 1.9 - 2.2 - 2.5



NOTE:  
 add nozzle Ø to Ref. (\*\*)

Recommended use:



**G1/SP**

Ref. 363\*\*

To be used through pressurized containers, low pressure pumps - Product inlet M1/4"  
 Body: nickel-plated sanded brass  
 Air cap: nickel-plated brass  
 Needle-nozzle-springs: stainless steel  
 Adjustments: product-fan  
 Weight: 620 g

Operating air pressure: MAX 3.0 bar  
 Air consumption: 370 l/min.  
 Ø nozzle: 1.9 - 2.2 - 2.5



NOTE:  
 add nozzle Ø to Ref. (\*\*)

Recommended use:



**G1/T**

Ref. 362\*\*

Adjustable suction pressure bayonet cup: 1000 cc stainless steel  
 Body: nickel-plated sanded brass  
 Air cap: nickel-plated brass  
 Needle-nozzle-springs: stainless steel  
 Adjustments: product  
 Cup gasket: o-ring in NBR  
 Equipped with regulator group of the air inlet and air pressure to the cup  
 Round spray  
 Weight: 1.67 Kg

Operating air pressure: MAX 3.0 bar  
 Air consumption: 230 l/min.  
 Ø nozzle: 1.9 - 2.2 - 2.5



NOTE:  
 add nozzle Ø to Ref. (\*\*)

Recommended use:



**G1/T SP**

Ref. 364\*\*

To be used through pressurized containers, low pressure pumps - Product inlet M1/4"  
 Body: nickel-plated sanded brass  
 Air cap: nickel-plated brass  
 Needle-nozzle-springs: stainless steel  
 Adjustments: product  
 Round spray  
 Weight: 620 g

Operating air pressure: MAX 3.0 bar  
 Air consumption: 230 l/min.  
 Ø nozzle: 1.9 - 2.2 - 2.5



NOTE:  
 add nozzle Ø to Ref. (\*\*)

Recommended use:



**RD** (with 680 cc nylon cup) - Ref. 36617

Body: nickel-plated sanded brass  
 Air cap: nickel-plated brass, swivelling 360° for lateral spraying  
 Needle-nozzle-springs: stainless steel  
 Adjustments: product -fan  
 Weight: 1.05 Kg

Operating air pressure: 3.0 - 4.0 bar  
 Air consumption: 130 - 200 l/min.  
 Ø nozzle: 1.7



Recommended use:



**EPD** Ref. 36700

Gun for pressurised dense products without atomization air.  
 Ideal for glue, sealant and lubricants.  
 Body: nickel-plated sanded brass  
 Barrel: 100 mm with product blocking on the tip, equipped with interchangeable flat spout in metal  
 Adjustments: product  
 Weight: 370 g

Operating air pressure: product MAX 3 bar



Recommended use:



**EPD/L** Ref. 36800

Gun for pressurised dense products without atomization air.  
 Ideal for glue, sealant and lubricants.  
 Body: nickel-plated sanded brass  
 Barrel: 150 mm, diam. int. 4 mm with product blocking at the tip of the barrel on the screwable nozzle  
 Adjustments: product  
 Weight: 345 g

Operating air pressure: product MAX 3 bar



Recommended use:



**MM** Ref. 62007

Cup: nylon 4.75 l  
 Body: varnished aluminium  
 Air cap: nickel-plated brass  
 Needle-springs: brass  
 Adjustments: product  
 Use: application of plastic wall paint  
 Weight: 1.36 Kg

Operating air pressure: 3.4 - 4.8 bar  
 Air consumption: 120 l/min.  
 Ø nozzle: 4.5 - 6.0 - 8.0



Recommended use:



# main spray gun **SPARE PARTS**

Main Asturomec® original spare parts supplied in practical packaging to maintain parts most subject to wear. Complete range of suction and gravity cups, available in the materials and sizes best suited for every type of use.



**CUPS**  
Complete range of POM C, aluminium, pressurised, upper and lower cups.

**ADC KIT**  
Needle, nozzle and air cap, essential spare parts for correct spray gun operations.

The ADC KIT contains needle-nozzle-air cap for the following models:

**10000**

10011 HVLP 10010 HVLP 10010/SP HVLP 10011 HVLP HD	
REF.	Ø
*1135310	1.0
1135313	1.3
1135315	1.5
1135317	1.7
1135319	1.9
1135322	2.2

\* only for "SP" model

10011 HTE 10010 HTE 10010/SP HTE 10011 HTE HD	
REF.	Ø
1135410	1.0
1135412	1.2
1135413	1.3
1135415	1.5
1135417	1.7
1135419	1.9
1135422	2.2
*1135425	2.5

\* except for "SP" model

9000

**9011 HVLP**

REF.	Ø
43013	1.3
43015	1.5
43017	1.7
43019	1.9
43022	2.2
43025	2.5

**9010 HVLP  
9010/SP HVLP**

REF.	Ø
*43110	1.0
*43113	1.3
43115	1.5
43117	1.7
43119	1.9
43122	2.2
43125	2.5

\* only for "SP" model

**9011 HTE**

REF.	Ø
43213	1.3
*43215	1.5
43217	1.7
*43219	1.9
*43222	2.2
*43225	2.5

\* for "HD" model too

**9010 HTE  
9010/SP HTE**

REF.	Ø
*43310	1.0
43313	1.3
43315	1.5
43317	1.7
43319	1.9
43322	2.2
43325	2.5

\* only for "SP" model

**9010 ECOMIX  
9010/SP ECOMIX**

REF.	Ø
43422	2.2
43425	2.5
43430	3.0

**9011 GEL COAT**

REF.	Ø
43630	3.0
43640	4.0
43650	5.0

**9010/SP GEL COAT**

REF.	Ø
43730	3.0
43740	4.0
43750	5.0

**9010/SP COLLA**

REF.	Ø
43517	1.7
43519	1.9

6000

**6011 HVLP**

REF.	Ø
43912	1.2
43914	1.4
43917	1.7
43919	1.9
43922	2.2
43925	2.5
43930	3.0

**6010 HVLP  
6010/SP HVLP**

REF.	Ø
43912	1.2
43914	1.4
43917	1.7
43919	1.9
43922	2.2
43925	2.5
43930	3.0

**6011 HTE**

REF.	Ø
44012	1.2
44014	1.4
44017	1.7
44019	1.9
44022	2.2
44025	2.5
44030	3.0

**6010 HTE  
6010/SP HTE**

REF.	Ø
44012	1.2
44014	1.4
44017	1.7
44019	1.9
44022	2.2
44025	2.5
44030	3.0

**OM GREEN  
IM GREEN  
OM - IM**

**OM GREEN**

REF.	Ø
40114	1.4
40117	1.7
40119	1.9
40122	2.2

**IM GREEN  
IM/SP GREEN**

REF.	Ø
40214	1.4
40217	1.7
40219	1.9
40222	2.2

**OM**

REF.	Ø
40160	1.0
40161	1.2
40162	1.4
40163	1.7
40164	1.9
40166	2.2
40167	2.5
40168	3.0
*40169	3.5
*40170	4.0

**IM - IM/SP**

REF.	Ø
40150	1.2
40151	1.4
40152	1.7
40153	1.9
40155	2.2
40156	2.5
40157	3.0

**GRAPHIC SERIES**

ES/RV		ES		RE		GRAPHIQUE	
REF.	Ø	REF.	Ø	REF.	Ø	REF.	Ø
40351	0.5	*40350	0.3	*40410	0.3	40361	0.3
40352	0.7	40356	0.5	40411	0.5		
40353	1.0	40357	0.7	40412	0.7		
40359	1.2	40358	1.0	40413	1.0		
				40414	1.2		

**UR PLUS UR/S PLUS**

UR/S PLUS UR PLUS/SP		UR PLUS		LOW PRESSURE SERIES		BP	
REF.	Ø	REF.	Ø			REF.	Ø
40320	1.2	40310	1.2			40370	1.4
40321	1.4	40311	1.4				
40322	1.7	40312	1.7				
40323	1.8	40313	1.8				
40324	1.9	40314	1.9				
40326	2.2	40316	2.2				
40327	2.5	40317	2.5				
40328	3.0	40318	3.0				

FLASH FLASH/M	
REF.	Ø
40375	1.4
40376	1.4

**SPECIAL SERIES**

G1 - G1/SP		G1/T G1/T SP		RD	
REF.	Ø	REF.	Ø	REF.	Ø
40380	1.9	40385	1.9	40395	1.7
40381	2.2	40386	2.2		
40382	2.5	40387	2.5		

**Set of gaskets includes: springs, rod, air valve for spray guns**

Model	REF.
10010/10011 all models	40761
9011 all models	40775
9010 all models	40770
6000 all models	40776
6010 SP all models	40777
OM - IM	40730
IM - SP	40732
UR/S PLUS- UR PLUS	40733
ES/RV	40715



Model	REF.
ES	40716
RE	40717
GRAPHIQUE	40720
RD	40730
BP	40750
FLASH	40751
G1-G1/T	40780
G1 SP - G1/T SP	40781

**GRAVITY CUPS: Nylon and Aluminium (M 12x1)**

**NYL. 680 cc**

Ref. 52010

680 cc nylon cup - weight: 215 g

Valid for models:

- 10011 (all models)**
- 9011 (all models)**
- 6011 (all models)**
- OM**
- RD**
- UR/S PLUS**



**NYL. 250 cc**

Ref. 52012

250 cc nylon cup - weight: 115 g

Valid for models:

- OM GREEN**
- OM**
- UR/S PLUS**



**ALU. 750 cc**

Ref. 52005

750 cc aluminium cup - weight: 170 g

Valid for models:

- 10011 (all models)**
- 9011 (all models)**
- 6011 (all models)**
- OM GREEN**
- OM**
- PRIMA**
- UR/S PLUS**



**ALU. 500 cc**

Ref. 52007

500 cc aluminium cup - weight: 116 g

Valid for models:

- 10011 (all models)**
- 9011 (all models)**
- 6011 (all models)**
- OM GREEN**
- OM**
- UR/S PLUS**



**Cups mod. Graphique**

20 cc glass suction cup - weight 30 g

Ref. 52039

4 cc anodized aluminium gravity cup - weight 10 g

Ref. 51040



**GRAVITY CUPS: Nylon and Aluminium (M 8x0.75)**

**NYL. 250 cc**

Ref. 52030

250 cc nylon cup - weight: 115 g

Valid for models:

**ES**  
**ES/RV**  
**RE**



**NYL. 75 cc**

Ref. 52032

75 cc nylon cup - weight: 54 g

Valid for models:

**ES**  
**ES/RV**  
**RE**



**ALU. 125 cc**

Ref. 52036

125 cc aluminium cup - weight: 170 g

Valid for models:

**ES**  
**ES/RV**  
**RE**



**PRESSURIZED GRAVITY CUPS for high-density products**

**Pressurized gravity cup-9011 HD**

680 cc nylon cup, complete with pressure regulator for spray gun inlet air, with pressure gauge.  
For high density products such as latex, polyurethane, gel coat, tixotropics, etc.  
Weight: 560 g

Ref. 52054

1000 cc aluminium cup, complete with pressure regulator for spray gun inlet air, with pressure gauge.  
For high density products such as latex, polyurethane, gel coat, tixotropics, etc.  
Weight: 560 g

Ref. 52053





**CAMLOCK cups for suction spray guns**

**ALU. 1000 cc**

1000 cc polished aluminium suction cup with cover  
Weight: 370 g Ref. 51002

1000 cc polished aluminium suction cup only  
Weight: 171 g Ref. 20100102083

Set of 5 pieces of gaskets for camlock cup Ref. 90119

Valid for models:

- 10010 HVLP**
- 10010 HTE**
- 9010 HVLP**
- 9010 HTE**
- 6010 HVLP**
- 6010 HTE**
- IM**
- UR PLUS**



**BAYONET cups for suction spray guns**

**ALU. 1000 cc**

1000 cc anodized aluminium suction cup with cover  
Weight: 171 g Ref. 51009

1000 cc anodized aluminium suction cup only  
Weight: 116 g Ref. 20100568183

Valid for models:

- 10010 HVLP**
- 9010 HVLP**
- 6010 HVLP**



**ALU. 1000 cc**

1000 cc polished aluminium suction cup with cover  
Weight: 300 g Ref. 51020

1000 cc polished aluminium suction cup only  
Weight: 116 g Ref. 20100568083

Set of 5 pieces of gaskets for camlock cup Ref. 90120

Valid for models:

- |                  |                |
|------------------|----------------|
| <b>10010 HTE</b> | <b>IM</b>      |
| <b>9010 HTE</b>  | <b>PRIMA</b>   |
| <b>6010 HTE</b>  | <b>UR PLUS</b> |



**Stainless steel BAYONET cups**

**1000 cc stainless steel**

1000 cc stainless steel suction cup with cover  
 Weight: 650 g Ref. 51030

1000 cc stainless steel suction cup only  
 Weight: 171 g Ref. 1011094

Set of 5 pieces of gaskets for stainless steel bayonet cup Ref. 90132

Valid for models:  
**9010 ECOMIX**  
**G1**  
**G1/T**



**SCREW CUPS**

**ALU. 1000 cc - FLASH** Ref. 20101044084

1000 cc stainless steel suction cup only  
 Weight: 196 g



**ALU. 1000 cc - BP** Ref. 20101044083

1000 cc stainless steel suction cup only  
 Weight: 124 g Ref. 20101044083

Set of 5 pieces of gaskets for screw cup Ref. 90126



# painting ACCESSORIES

Professional accessories designed to facilitate bodyworks, guaranteeing maximum efficiency and practicality, demonstrating that even details are important in quality works. A complete ranges, from regulators to masks, clothing to Personal Protection Equipment, specific paint booth hoses and paint filters. All this designed and manufactured by Walmecc exclusively for professionals.

## PAPER SIEVE

Practical, efficient, disposable sieve for correct paint filtering.

## MASK

Complete with helmet, visor and internal air regulator; required for workman's safety in the paint booth.

## GOGGLES

Light weight and ergonomic, they guarantee maximum safety during work.

## MASKS

Active carbon or dust-proof, they offer suitable respiratory tract protection.

## SKELETON

Spray gun bench stand with upper cup.



## GLOVES

Made of latex, paint and solvent resistant, they let the operator work in fully clean conditions.

**Regulator**

Ref. 90105

Air flow regulator with glass pressure gauge and metallic case to be applied to the spray gun air inlet  
 Pressure gauge: range 0 - 10 bar  
 Air inlet: 1/4" U compatible with various standard 1/4"

Package: 1 pcs  
 Weight: 150 g



**Regulator**

Ref. 90106

Air flow regulator to be applied to the spray gun air inlet  
 Air inlet: 1/4" U compatible with various standard 1/4"

Package: 1 pcs  
 Weight: 75 g



**Gauge**

Ref. 61306

Spare gauge for air flow regulator  
 Connection: M 1/8"  
 Diameter: 40 mm

Operating air pressure: 0 - 10 bar  
 Package: 1 pcs  
 Weight: 70 g



**HELMET mask**

Ref. 50400

Approved protective mask consisting of:  
 - visored helmet with internal ventilation,  
 - pressure drop safety buzzer,  
 - polyurethane hose for spray gun connections,  
 - filtering kit with carbon filters,  
 - belt,  
 - 2 spare adhesive visor cover,  
 - CE0194 approved - EN1459N:2005 class A standard compliant

Package: 1 pcs  
 Weight: 1,2 Kg



**SAFETY PLUS mask**

Ref. 50410

Protective mask with 2 active carbon filters  
 - Meet EEC standards, 89/686/EEC directive  
 Package: 1 pcs  
 Weight: 320 g

Spare filter for Ref. 50410 - weight 100 g

Ref. 50411



**SAFETY mask**

Ref. 50416

Protective mask with 1 active carbon filter  
 - Meet EEC standards, 89/686/EEC directive  
 Package: 1 pcs  
 Weight: 280 g

Spare filter for Ref. 50416 - weight 100 g

Ref. 50417



## Paint mask

Ref. 50418

FFP2S active carbon filter face mask, suited for painting.

Package: 10 pcs  
Weight: 260 g



## Dust mask

Ref. 50419

FFP1 dust-proof filter face mask.

Package: 50 pcs  
Weight: 160 g



## Goggles

Ref. 50420

V-Maxx protective goggle mask with AC lenses + 2 lens covers

Package: 5 pcs  
Weight: 375 g



## Gloves

Ref. 50421

Latex, non-sterile ambidextrous paint gloves.  
Paint and solvent resistant.

Package: 50 pcs  
Weight: 2 Kg

One size fits all



## Supporter

Ref. 60130/A

Magnetic holder for spray guns with gravity cups.  
Can also be affixed to non-ferrous surfaces using supplied screws.  
Features: painted steel

Package: 1 pcs  
Dimensions cm: L 20 x P 14.5 x H 23.2 cm  
Weight: 1.5 Kg



## Skeleton

Ref. 60149

Holder for spray guns with gravity cups. Simple, stable and ergonomic,  
suited for any spray gun.  
Features: galvanised steel

Package: 1 pcs  
Dimensions cm: L 13 x P 20 x H 29 cm  
Weight: 390 g



## Filter

Ref. 90111

Steam trap filter with filler component and steam release valve to be fitted at the inlet of the spray gun.

Package: 1 pcs  
Weight: 100 g



## Filter

100-mesh (750 µm) complete filter for pressure fed spray guns, **F/M 3/8"** version\* Ref. 60097

100-mesh (750 µm) complete filter for pressure fed spray guns, **F/M 1/4"** version \* Ref. 60098

100-mesh (750 µm) complete filter for Ref. 60097 \*\* Ref. 412012

\* Package: 1 pcs  
Weight: 50 g

\*\* Package: 1 pcs  
Weight: 25 g



## Filter

Ref. 90112

2000-mesh (160 µm) stainless steel paint filter to be attached to the suction pipe of spray guns with suction cups.

Package: 10 pcs  
Weight: 50 g



## Filter

Ref. 90113\*\*

Nylon paint filter to be attached to the suction pipe of spray guns with suction cups.

\*\* Specify: 5000 - 7000 - 10000 mesh (90 µm-75 µm-60 µm)

Package: 10 pcs  
Weight: 65 g



## Filter

Ref. 90114/A

2000-mesh (160 µm) nylon paint filter to be attached to the spray gun with gravity cups for touch-ups

Package: 10 pcs  
Weight: 40 g



## Sieve

Ref. 90115\*\*

Nylon sieve for paint

\*\*Specify: 2000 - 5000 - 7000 - 10000 - 15000 - 17000 mesh (160 µm-90 µm-75 µm- 60 µm-45 µm-40 µm)

Package: 10 pcs  
Weight: 300 g



## Paper sieve

Disposable paper paint sieve.

1000 mesh version (190 µm)

Ref. 90146.10

2500 mesh version (125 µm)

Ref. 90146.25

Package: 250 pcs

Weight: 1.473 Kg



## Viscosimeter

Ref. 90116

"FORD 4" viscosimeter cup to test paint viscosity.

Package: 3 pcs

Weight: 270 g



## Gauge protector

from 39 to 43 mm

Ref. 90128/A

from 63 mm

Ref. 90129/A

Transparent shockproof and paint-proof pressure gauge guard, washable with solvent.

Package: 10 pcs

Weight: 10 g

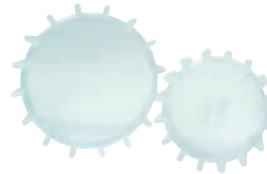

## Captest

Ref. 90124\*\*

Captest for 9010-9011 HVLP spray guns. air cap with gauge attached so as to verify the effective air pressure at the air cap outlet.

Gauge: range 0 - 2.5 bar

Weight: 270 g

Ø nozzle: 1.0 - 1.3 - 1.5 - 1.7 - 1.9 - 2.2 - 2.5

Weight: 3 pcs



# PRESSURIZED CONTAINERS and LOW PRESSURE PUMP

Ideal for the use of large amounts of product, suggested for wood industry, carpentry, industrial painting, for the application of vinyl and neoprene glues, tar, abrasive pastes and liquids.  
Considering the dimensions the product can be poured directly into the tank or placed inside its own container to avoid cleaning. No special maintenance requirements.  
A 30 l/min. low pressure pump has been added to the range in order to facilitate work on large surfaces, ideal for any type of use.

**CLOSURE**  
High seal hand wheel closure, with toroidal lid gasket.

**OUTPUT**  
Fitting for 2 spray guns, to provide maximum production efficiency at the work place.

**SAFETY VALVE**  
Certified brass safety valve with automatic pressure release at 3 bar.

**TANK**  
Black electrophoresis treatment in the tank to guarantee maximum resistance even with paint or solvent deposits.

**SSP 24 AP**  
Ref. 90019AP

**TANK CERTIFICATION**

AUTORIZZAZIONE ALLA MARCATURA CE	
MODELLO A1	
Riferimento alla direttiva: A1 2010 ME PP 199	
Riferimento alla direttiva: A1 2010 ME PP 199	
Riferimento alla direttiva: A1 2010 ME PP 199	
Modello	SSP 24 AP
Descrizione	CONTENITORE PRESSURIZZATO
Materiali	ACCIAIO INOX
Dimensioni	Ø 300 x 450
Pressione massima	3 bar
Pressione di lavoro	2 bar
Volume	24 litri
Capacità	24 litri
Temperatura massima	60 °C
Temperatura minima	5 °C
Temperatura ambiente	15 °C
Temperatura di esercizio	5 - 60 °C
Temperatura di conservazione	5 - 60 °C
Temperatura di trasporto	5 - 60 °C
Temperatura di stoccaggio	5 - 60 °C
Temperatura di smaltimento	5 - 60 °C



**SSP 5**

Ref. 90015

Container and fluid passages: stainless steel  
 Product pressure regulator  
 Coupling for 1 spray gun

Air outlet connection: M 1/4"  
 Product outlet connection: M 1/4"  
 Tank capacity: 9 l  
 Weight: 4 Kg



Recommended use:



**SSP 20**

Ref. 90020

Container and fluid passages: stainless steel  
 Product pressure regulator  
 Coupling for 1 spray gun

Air outlet connection: M 1/4"  
 Product outlet connection: M 1/4"  
 Tank capacity: 18 l  
 Weight: 4.5 Kg



Recommended use:



**SSP 10**

Ref. 90018

Internal removable tank: aluminium  
 Safety valve and product pressure regulator  
 Coupling for 1 spray gun  
 Product pipe rapid washing system  
 Cover: aluminium, surface treated with black cataphoresis, closure with 4 tie-rods  
 Container: steel, treated with black cataphoresis  
 Fittings and internal components: stainless steel

Air outlet connection: M 1/4"  
 Product outlet connection: M 1/4"  
 Tank capacity: 5.5 l  
 Weight: 13.5 Kg



Recommended use:



**SSP 10PL**

Ref. 90018PL

Safety valve and product pressure regulator  
 Coupling for 1 spray gun  
 Material outlet at bottom of tank: for dense product  
 Cover: aluminium, surface treated with black cataphoresis, closure with 4 tie-rods  
 Container: steel, treated with black cataphoresis  
 Fittings and internal components: stainless steel

Air outlet connection: M 1/4"  
 Product outlet connection: M 1/4"  
 Tank capacity: 10 l  
 Weight: 14.5 Kg



Recommended use:



## SSP 24

Ref. 90019

\*Ref. 90019/CE

Internal removable tank: polyethylene  
 Container: black cataphoresis, with reinforced top  
 Safety valve and product pressure regulator  
 Coupling for 2 spray guns  
 Product pipe washing system  
 Product stirrer: manual  
 Cover: steel, surface treated with black cataphoresis, closure with 5 tie-rods supplied with seal toroidal gasket, complete with tap in zinc steel  
 Fittings and internal components: stainless steel

Air outlet connection: M 1/4" - Product outlet connection: M 1/4"  
 Tank capacity: 16 l  
 Weight: 34 Kg \*Optional: Meet EEC standards



Recommended use:



## SSP 24 PL

Ref. 90019PL

\*Ref. 90019/PL/CE

Container: black cataphoresis, with reinforced top  
 Safety valve and product pressure regulator  
 Coupling for 2 spray guns  
 Product stirrer: manual  
 Material outlet at bottom of tank: for dense product  
 Cover: steel, surface treated with black cataphoresis, closure with 5 tie-rods supplied with seal toroidal gasket, complete with tap in zinc steel for adding product  
 Fittings and internal components: stainless steel

Air outlet connection: M 1/4" - Product outlet connection: M 1/4"  
 Tank capacity: 24 l  
 Weight: 33 Kg \*Optional: Meet EEC standards



Recommended use:



## SSP 24 AP

Ref. 90019AP

\*Ref. 90019/AP/CE

Internal removable tank: polyethylene  
 Container: black cataphoresis, with reinforced top  
 Safety valve and product pressure regulator  
 Coupling for 2 spray guns  
 Product pipe rapid washing system  
 Product stirrer: pneumatic  
 Cover: steel, surface treated with black cataphoresis, closure with 5 tie-rods supplied with seal toroidal gasket, complete with tap in zinc steel for adding product.

Air outlet connection: M 1/4" - Product outlet connection: M 1/4"  
 Tank capacity: 16 l  
 Weight: 38.5 Kg \*Optional: Meet EEC standards



Recommended use:



## WM 30

Ref. 90050

Low pressure pump equipped with DOUBLE DIAPHRAGM PRESSURE REGULATOR.  
 For all kinds of paint, primers, colour and finishing

Operating air pressure: MAX 6 bar  
 Air consumption: MAX 30 l/min  
 Weight: 19 Kg



Recommended use:



## Double hose

Black rubber hose for compressed air 6x14  
Transparent Rilsan hose for product 8x10

7 m version - weight 1.6 Kg	Ref. 90032
10 m version - weight 2.3 Kg	Ref. 90035
14 m version - weight 3.2 Kg	Ref. 90034

Connection: F1/4" on product hose-bayonet on air hose  
Package: 1 pcs



## Double hose

Flexible bicolour hose in SBR/EPDM rubber  
Blue hose for compressed air 6x13  
Red hose for product 6x13

10 m version	Ref. 90036
7 m version	Ref. 90037

Air/product connection: F1/4"  
Weight: 3.3 - 2.4 Kg  
Package: 1 pcs



## Aluminium tank

Ref. A008051

Internal aluminium tank for SSP 24 and SSP 24 AP

Package: 1 pcs  
Weight: 1.3 Kg



## Wheels

Ref. 90025

4 clamp kit wheels for SSP10 and SSP24

Package: 4 pcs  
Weight: 1.95 Kg



# BLOW GUNS

Designed and constructed for professional use, they are divided into 4 macro groups: PROFI series, PA/4N series, SOFT series and the new, captivating and modern PA/6 series.

Always functional and reliable, they now also meet the more demanding customer's needs with versions enhanced by the modern and innovative design.

The new PA/6 is a demonstration, combining functional quality with a unique design made possible by the grip's soft-touch rubber overprinting.

The wide range of available nozzles make Asturomec® blow guns flexible and suited for more specific use. The entire series is equipped with progressive distribution valve.

## PROGRESSIVE VALVE

The distinguishing element in our blow guns, they accurately and reliably dose the amount of air to be used.



## PA/6

Nickel-plated body with soft-touch rubber overprinting for a sure and comfortable grip. One of a kind, the PA/6 represents Asturomec's future.



## PA/4NT Ref. 50071

## PA/4NT

Innovative and captivating materials like the transparent nylon that identifies this full "vision" gun.



## PA/6 Ref. 50065

## PROFI

9 models available to meet the professional's specific needs. A gun that represents our brand and reliability.



**PROFI**

Ref. 50000

Professional blow gun.  
 Finely adjustable progressive flow delivery valve with spring in stainless steel  
 Air inlet: M 1/4" with swivel connection FF  
 Body: hostaform C®  
 Barrel: 150 mm curved

Operating air pressure: 1.0 - 6.0 bar  
 Package: 6 pcs  
 Weight: 845 g



Recommended use:



**PROFI**

Ref. 50001

Professional blow gun.  
 Finely adjustable progressive flow delivery valve with spring in stainless steel  
 Air inlet: M 1/4" with swivel connection FF  
 Body: hostaform C®  
 Barrel: 300 mm extra-long

Operating air pressure: 1.0 - 6.0 bar  
 Package: 1 pcs  
 Weight: 165 g



Recommended use:



**PROFI**

Ref. 50003

Professional blow gun with non-scratching rubber tip.  
 Finely adjustable progressive flow delivery valve with spring in stainless steel  
 Air inlet: M 1/4" with swivel connection FF  
 Body: hostaform C®  
 Barrel: 150 mm extra-long

Operating air pressure: 1.0 - 6.0 bar  
 Package: 6 pcs  
 Weight: 870 g



Recommended use:



**PROFI**

Ref. 50004

Professional blow gun.  
 Finely adjustable progressive flow delivery valve with spring in stainless steel  
 Air inlet: M 1/4" with swivel connection FF  
 Body: hostaform C®  
 Barrel: 1 m with flexible copper barrel

Operating air pressure: 1.0 - 6.0 bar  
 Package: 1 pcs  
 Weight: 270 g



Recommended use:



**PROFI**

Ref. 50005

Professional liquid atomising gun for washing, degreasing and lubricating with naphtha and diesel.

Finely adjustable progressive flow delivery valve with spring in stainless steel

Air inlet: M 1/4" with swivel connection FF

Body: hostaform C®

Hose: da 3 m

Operating air pressure: 1.0 - 6.0 bar

Package: 1 pcs

Weight: 295 g



Recommended use:



**PROFI**

Ref. 50006

Professional blow gun with silenced nozzle in compliance with CE standards.

Noise level inferior to 80 DbA

Finely adjustable progressive flow delivery valve with spring in stainless steel

Air inlet: M 1/4" with swivel connection FF

Body: hostaform C®

Barrel: 150 mm curved

Operating air pressure: 1.0 - 6.0 bar

Package: 6 pcs

Weight: 920 g



Recommended use:



**PROFI**

Ref. 50007

Professional blow gun with Venturi nozzle for increasing the outlet air volume.

Finely adjustable progressive flow delivery valve with spring in stainless steel

Air inlet: M 1/4" with swivel connection FF

Body: hostaform C®

Barrel: 150 mm curved

Operating air pressure: 1.0 - 6.0 bar

Package: 1 pcs

Weight: 155 g



Recommended use:



**PROFI**

Ref. 50008

Professional blow gun with anti-splintering safety nozzle.

Finely adjustable progressive flow delivery valve with spring in stainless steel

Air inlet: M 1/4" with swivel connection FF

Body: hostaform C®

Barrel: 150 mm curved

Operating air pressure: 1.0 - 6.0 bar

Package: 1 pcs

Weight: 160 g



Recommended use:



### PROFI

Ref. 50009

Professional blow gun with safety nozzle in compliance with OSHA (USA) standards.  
 Finely adjustable progressive flow delivery valve with spring in stainless steel  
 Air inlet: M 1/4" with swivel connection FF  
 Body: hostaform C®  
 Barrel: 150 mm curved

Operating air pressure: 1.0 - 6.0 bar  
 Package: 1 pcs  
 Weight: 150 g



Recommended use:



### PA/6

Ref. 50065

Blow gun with progressive flow delivery valve.  
 Body: polished and nickel-plated metal with soft-touch rubber overprinting  
 Nozzle: short

Operating air pressure: 1.0 - 6.0 bar  
 Package: 10 pcs  
 Weight: 2.38 Kg



Recommended use:



### PA/6L - PA/6LL

Blow gun with progressive flow delivery valve.  
 Body: polished and nickel-plated metal with soft-touch rubber overprinting

Barrel: 150 mm straight - **PA/6L** version (\*) Ref. 50066

Barrel: 300 mm straight - **PA/6LL** version (\*\*) Ref. 50067

Operating air pressure: 1.0 - 6.0 bar  
 Package: 1 pcs  
 (\*) weight: 254 g - (\*\*) weight: 274 g



Recommended use:



### PA/6CV

Ref. 50068

Blow gun with progressive flow delivery valve.  
 Body: polished and nickel-plated metal with soft-touch rubber overprinting  
 Nozzle: Venturi, for increasing the outlet air volume

Operating air pressure: 1.0 - 6.0 bar  
 Package: 1 pcs  
 Weight: 271 g



Recommended use:



**PA/4N**

Ref. 50047

Blow gun with progressive flow delivery valve.  
 Body: nylon  
 Nozzle: short

Operating air pressure: 1.0 - 6.0 bar  
 Package: 10 pcs  
 Weight: 1.9 Kg



Recommended use:



**PA/4NL - PA/4NLL**

Blow gun with progressive flow delivery valve  
 Body: nylon

Barrel: 150 mm straight - **PA/4NL** version (\*) Ref. 50048

Barrel: 300 mm straight - **PA/4NLL** version (\*\*) Ref. 50049

Operating air pressure: 1.0 - 6.0 bar  
 Package: 1 pcs  
 (\*) Weight: 200 g - (\*\*) Weight: 225 g



Recommended use:



**PA/4NP**

Ref. 50050

Blow gun with specific needle for inflating balls  
 Finely adjustable progressive flow delivery valve with spring in stainless steel  
 Body: nylon

Operating air pressure: 1.0 - 6.0 bar  
 Package: 5 pcs  
 Weight: 1.9 Kg



**PA/4NT**

Ref. 50071

Blow gun with progressive flow delivery valve.  
 Body: clear nylon  
 Nozzle: short

Operating air pressure: 1.0 - 6.0 bar  
 Package: 10 pcs  
 Weight: 1.9 Kg



Recommended use:





### PA/4NTL - PA/4NTLL

Blow gun with progressive flow delivery valve.  
Body: clear nylon

Barrel: 150 mm straight - **PA/4NTL** version (\*) Ref. 50072

Barrel: 300 mm straight - **PA/4NTLL** version (\*\*) Ref. 50073

Operating air pressure: 1.0 - 6.0 bar  
Package: 1 pcs  
(\*) Weight: 200 g - (\*\*) Weight: 225 g



Recommended use:



### PA/4N - PA/4NT: SICURA

Blow gun equipped with a progressive distribution valve with splinter-proof, scratchproof nozzle, EC standard muffled, OSHA safe (USA)  
Body: in nylon/ clear nylon

nylon version **PA/4N SICURA** (\*) Ref. 50046

clear nylon version **PA/4NT SICURA** (\*\*) Ref. 50070

Operating air pressure: 1.0 - 6.0 bar  
Package: 5 pcs  
(\*) Weight: 1.8 Kg - (\*\*) Weight: 2.0 Kg



Recommended use:



### SOFT

Ref. 50020

Extremely small blow gun (105 x 25 mm). equipped with progressive distribution valve.  
Body: rubber  
Fitting: F1/4"

Operating air pressure: 1.0 - 6.0 bar  
Package: 1 pcs  
Weight: 60 g



Recommended use:



### SOFT

Ref. 50026

Extremely small blow gun (105 x 25 mm). equipped with progressive distribution valve.  
Body: rubber  
Fitting: M1/4" with 4 m polyurethane spiral air hose

Operating air pressure: 1.0 - 6.0 bar  
Package: 1 pcs  
Weight: 180 g



Recommended use:



### SPECIAL NOZZLE

Ref. 90150

OSHA safety nozzle, spare part for PROFI ref. 50009.

Compatible with:

PROFI	ref. 50000
PROFI	ref. 50001
PA/6L	ref. 50066
PA/6LL	ref. 50067
PA/4NL	ref. 50048
PA/4NLL	ref. 50049
PA/4NTL	ref. 50072
PA/4NTLL	ref. 50073

Package: 5 pcs  
Weight: 300 g



Recommended use:



### SPECIAL NOZZLE

Ref. 90151

Anti-splintering nozzle, spare part for PROFI ref. 50008.

Compatible with:

PROFI	ref. 50000
PROFI	ref. 50001
PA/6L	ref. 50066
PA/6LL	ref. 50067
PA/4NL	ref. 50048
PA/4NLL	ref. 50049
PA/4NTL	ref. 50072
PA/4NTLL	ref. 50073

Package: 2 pcs  
Weight: 90 g



Recommended use:



### SPECIAL NOZZLE

Ref. 90152

VENTURI nozzle, spare part for PROFI ref. 50007.

Compatible with:

PROFI	ref. 50000
PROFI	ref. 50001
PA/6L	ref. 50066
PA/6LL	ref. 50067
PA/4NL	ref. 50048
PA/4NLL	ref. 50049
PA/4NTL	ref. 50072
PA/4NTLL	ref. 50073

Package: 5 pcs  
Weight: 225 g



Recommended use:



### SPECIAL NOZZLE

Ref. 90153

Silenced nozzle in compliance with EC standards, spare part for PROFI ref. 50006.

Compatible with:

PROFI	ref. 50000
PROFI	ref. 50001
PA/6L	ref. 50066
PA/6LL	ref. 50067
PA/4NL	ref. 50048
PA/4NLL	ref. 50049
PA/4NTL	ref. 50072
PA/4NTLL	ref. 50073

Package: 5 pcs  
Weight: 375 g



**SPECIAL NOZZLE**

Ref. 90154

Atomiser nozzle and 3 m hose, spare part for PROFI ref. 50005.

Compatible with:

PROFI	ref. 50000
PROFI	ref. 50001
PA/6L	ref. 50066
PA/6LL	ref. 50067
PA/4NL	ref. 50048
PA/4NLL	ref. 50049
PA/4NTL	ref. 50072
PA/4NTLL	ref. 50073

Package: 1 pcs  
Weight: 170 g



Recommended use:



**SPECIAL NOZZLE**

Ref. 90155

Non-scratch tip, spare part for PROFI ref. 50003.

Compatible with:

PROFI	ref. 50000
PROFI	ref. 50001
PA/6L	ref. 50066
PA/6LL	ref. 50067
PA/4NL	ref. 50048
PA/4NLL	ref. 50049
PA/4NTL	ref. 50072
PA/4NTLL	ref. 50073

Package: 5 pcs  
Weight: 125 g



Recommended use:



**SPECIAL NOZZLE**

Ref. 901025

1 meter flexible copper barrel, spare part for PROFI ref. 50004.

Package: 1 pcs  
Weight: 180 g



Recommended use:



# INFLATING GUNS

Accurate and reliable, they have always been a measurement instrument selected and appreciated by the most demanding professionals and DIY lovers.

From the legendary PG/S to the brand new PG/PRO, the result of years of technical, functional and aesthetic research associated with decades of experience in this sector, the Asturomec® inflation gun range is the most complete and professional range on the market.

Precision instruments with top quality pressure gauges, equipped with FAIL SAFE GAUGE SAFETY VALVE that prevents gauge needle oscillations during use, cutting it off from the air line during inflation.

Available in the CEE/OM version, meeting EEC D96 18.08.02 nr. 71/316 directive standards for pressure gauges and gun (check First).



**PG PRO CEE/OM**

Ref. 50180/O

Professional inflating gun **EEC approved.**  
 Pressure-gauge protecting safety valve  
 Body: nickel-plated brass, Marfran C shockproof and nonslip grip  
 Lever: single pressure load made of stainless steel  
 Two-way release button: fast or regulation  
 PVS pressure reading system  
 Gauge: diam. 80 mm EEC approved-range 0-10 bar  
 Length of tube: 1 m

Operating air pressure: 1.0 - 6.0 bar  
 Package: 1 pcs  
 Weight: 910 g



Recommended use:



**PG/G PRO CEE/OM**

Ref. 50181/O

Professional inflating gun **EEC approved, for twin or spoked wheels.**  
 Pressure-gauge protecting safety valve  
 Brass inflating head, 30 cm long  
 Body: nickel-plated brass, Marfran C shockproof and nonslip grip  
 Lever: single pressure load made of stainless steel  
 Two-way release button: fast or regulation  
 PVS pressure reading system  
 Gauge: diam. 80 mm EEC approved-range 0-10 bar  
 Length of tube: 1 m

Operating air pressure: 1.0 - 6.0 bar  
 Package: 1 pcs  
 Weight: 1.02 Kg



Recommended use:



**PG PRO**

Ref. 50182

Professional inflating gun.  
 Pressure-gauge protecting safety valve  
 Body: nickel-plated brass, Marfran C shockproof and nonslip grip  
 Lever: single pressure load made of stainless steel  
 Two-way release button: fast or regulation  
 PVS pressure reading system  
 Gauge: diam. 80 mm - range 0-10 bar  
 Length of tube: 1 m

Operating air pressure: 1.0 - 6.0 bar  
 Package: 1 pcs  
 Weight: 800 g



**PG/G PRO**

Ref. 50183

Professional inflating gun, for twin or spoked wheels.  
 Pressure-gauge protecting safety valve  
 Brass inflating head, 30 cm long  
 Body: nickel-plated brass, Marfran C shockproof and nonslip grip  
 Lever: single pressure load made of stainless steel  
 Two-way release button: fast or regulation  
 PVS pressure reading system  
 Gauge: diam. 80 mm - range 0-10 bar  
 Length of tube: 1 m

Operating air pressure: 1.0 - 6.0 bar  
 Package: 1 pcs  
 Weight: 930 g



Recommended use:



**PG/S CEE/OM**

Ref. 50108/O

Inflating gun **EEC approved.**  
 Pressure-gauge protecting safety valve  
 Body: nylon  
 Lever: single operation with double acting pressing filling and release lever  
 Gauge: diam 63 mm EEC approved-range 0-10 bar  
 Length of tube: 80 cm

Operating air pressure: 1.0 - 6.0 bar  
 Package: 1 pcs  
 Weight: 460 g



Recommended use:



**PG/SG CEE/OM**

Ref. 50109/O

Inflating gun **EEC approved, for twin or spoked wheels.**  
 Pressure-gauge protecting safety valve  
 Brass inflating head, 30 cm long  
 Body: nylon  
 Lever: single operation with double acting pressure filling and release lever  
 Gauge: diam 63 mm EEC approved-range 0-10 bar  
 Length of tube: 80 cm

Operating air pressure: 1.0 - 6.0 bar  
 Package: 1 pcs  
 Weight: 590 g



**PG/S**

Ref. 50106

Inflating gun.  
 Pressure-gauge protecting safety valve  
 Body: nylon  
 Lever: single operation with double acting pressure filling and release lever  
 Gauge: diam. 63 mm double range bar/psi  
 Length of tube: 80 cm

Operating air pressure: 1.0 - 6.0 bar  
 Package: 1 pcs  
 Weight: 440 g



Recommended use:



**PG/SG**

Ref. 50107

Inflating gun, for twin or spoked wheels.  
 Pressure-gauge protecting safety valve  
 Brass inflating head, 30 cm long  
 Body: nylon  
 Lever: single operation with double acting pressure filling and release lever  
 Gauge: diam. 63 mm double range bar/psi  
 Length of tube: 80 cm

Operating air pressure: 1.0 - 6.0 bar  
 Package: 1 pcs  
 Weight: 570 g



Recommended use:



### CP

Pressure gauge for checking pressure - double range bar/psi Ref. 50120

Pressure gauge for checking pressure - single range bar Ref. 50120/BAR

Gauge: diameter 63 mm  
 Package: 1 pcs  
 Weight: 260 g



Recommended use:



### INFLATING HEAD

Polyamide + fibreglass version - diam. 6 mm - weight 560 g Ref. 50121

Polyamide + fibreglass version - diam. 8 mm - weight 560 g Ref. 50134

Turned brass version - diam. 6 mm - weight 660 g Ref. 50127

Turned brass version - diam. 8 mm - weight 660 g Ref. 50128

Inflating head with PRESTA valve, PRESTA HIGH, PRESTA HIGH PLUS - use: for racing bicycles - weight 685 g Ref. 50132

Package: 25 pcs



Recommended use:



### INFLATING HEAD

Special GEM brass inflation head for paired or spoke wheels, compatible with hose diam. 6/8 mm

300 mm long version - complete with grip (\*) Ref. 50123

200 mm long version (\*\*) Ref. 50122

Package: 3 pcs  
 (\*) Weight: 460 g - (\*\*) Weight: 290 g



Recommended use:



### INFLATING KIT

Ref. 50125

Inflation kit made up of 3 pcs.  
 Material: brass/steel  
 Use: bicycles, rafts, balls

Package: 1 pcs  
 Weight: 40 g



Recommended use:



# WASHING GUNS

Guns designed specifically for washing, lubrication, degreasing, spraying, disinfecting and decontaminating in multiple sectors: from workshops to industry, from construction and beatyards to agriculture, garages, bodyshops and D.I.Y.





## N4/S SUPER

Ref. 50171

Professional cleaning gun suited for any type of use, the air flow can be locked at a set quantity.

Bayonet suction cup: aluminium 1000 cc

Body: aluminium

Adjustable liquid atomising nozzle: nickel-plated brass

Barrel: nickel-plated brass - 300 mm long

Filler opening: diam 8.5 cm

Operating air pressure: 2.0 - 8.0 bar

Package: 1 pcs

Weight: 1.08 Kg



Recommended use:



## N4/S

Ref. 50172

Professional washing gun suitable for every use.

Bayonet suction cup: aluminium 1000 cc

Body: aluminium

Adjustable liquid atomising nozzle: nickel-plated brass

Barrel: nickel-plated brass - 200 mm long

Filler opening: diam 8.5 cm

Operating air pressure: 2.0 - 8.0 bar

Package: 1 pcs

Weight: 1 Kg



Recommended use:



## N4

Ref. 50173

Professional washing gun suitable for every use.

Bayonet cup with screw closure: 1000 cc aluminium

Body: aluminium

Adjustable liquid atomising nozzle: nickel-plated brass

Barrel: nickel-plated brass - 200 mm long

Filler opening: diam 8.5 cm

Operating air pressure: 2.0 - 8.0 bar

Package: 2 pcs

Weight: 1.51 Kg



Recommended use:



## LA

Ref. 50165

Gun for mixing liquid with compressed air.

Body: nickel-plated brass

Water fitting: push-on for 12 mm internal Ø hose to be tightened with a strap

Adjustment of liquid flow using ball valve

Operating air pressure: 4.0 - 8.0 bar

Package: 1 pcs

Weight: 950 g



Recommended use:



## HYDROJET

Ref. 50160

Liquid mixing gun with compressed air, equipped with 2 independent valves to dose air and liquid and progressive opening lever for flow regulation.

Body: hostaform C®

Water fitting: push-on for 12 mm internal Ø hose to be tightened with a strap - M1/4"

Operating air pressure: 1.0 - 6.0 bar

Package: 1 pcs

Weight: 440 g



Recommended use:



# SANDBLASTING GUNS

Ideal for all tasks which involve cleaning, scraping, removing rust, paint, mold or stubborn dirt, preparing materials such as wood, steel, aluminium, plastic, etc...  
Used in numerous sectors: bodyshops, industry and carpentry.



**PS**

Ref. 50210

Sandblasting gun suitable for work on large surfaces.  
 Body: nickel-plated sanded brass  
 Nozzle: cemented casehardened steel Ø 6 mm  
 Immersed hoses: 2 m hose - diameter 16x22

Operating air pressure: 5.0 - 8.0 bar  
 Package: 1 pcs  
 Weight: 1.75 Kg



Recommended use:



**PS/S**

Ref. 50212

Sandblasting gun suitable for work on large surfaces.  
 Bayonet suction cup: aluminium 1000 cc  
 Body: nickel-plated sanded brass  
 Nozzle: cemented casehardened steel Ø 6 mm

Operating air pressure: 5.0 - 8.0 bar  
 Package: 1 pcs  
 Weight: 1.15 Kg



Recommended use:



**PS/I**

Ref. 50314

Sandblasting gun suitable for work on medium surfaces.  
 Body: polished and nickel-plated metal with soft-touch rubber overprinting  
 Nozzle: cemented casehasrdened steel Ø 6 mm with sand flow rate adjustment  
 Immersed hoses: 3 m hose - diameter 8x13

Operating air pressure: 5.0 - 8.0 bar  
 Package: 1 pcs  
 Weight: 940 g



Recommended use:



**PS/IS**

Ref. 50316

Sandblasting gun suitable for work on medium surfaces.  
 Bayonet suction cup: aluminium 1000 cc  
 Body: polished and nickel-plated metal with soft-touch rubber overprinting  
 Nozzle: cemented casehasrdened steel Ø 6 mm with sand flow rate adjustment

Operating air pressure: 5.0 - 8.0 bar  
 Package: 1 pcs  
 Weight: 920 g



Recommended use:



## NOZZLE

6 mm external Ø nozzle for **PS** and **PS/S** (\*)  
cemented and tempered steel version Ref. 20201644094

6 mm external Ø nozzle for **PS** and **PS/S** (\*)  
tungsten carbide version Ref. 20201644294

Ø 6 mm sand output nozzle for **PS/I** and **PS/IS** (\*\*)  
cemented and tempered steel version Ref. 20201682494

Ø 6 mm sand output nozzle for **PS/I** and **PS/IS** (\*\*)  
tungsten carbide version Ref. 20201682294

Package: 1 pcs

(\*) Weight: 105 g - (\*\*) Weight: 75 g

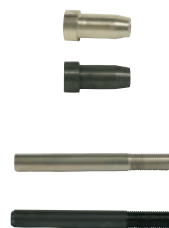

Recommended use:



## SUPERMISTRAL

Ref. 50300

Sandblasting gun suitable for work on small surfaces and fitted with automatic sand recovery system, possibility to adjust the vacuum power.

Bayonet suction cup: aluminium 1000 cc

Body: polished and nickel-plated metal with soft-touch rubber overprinting

Featuring: 4 rubber nozzle kit

1 abrasive sand box of 700 g

Operating air pressure: 5.0 - 8.0 bar

Package: 1 pcs

Weight: 2.4 Kg



Recommended use:



## MISTRAL

Ref. 50301

Sandblasting gun suitable for work on small surfaces and fitted with automatic sand recovery system.

Bayonet suction cup: aluminium 1000 cc

Body: polished and nickel-plated metal with soft-touch rubber overprinting

Featuring: 1 abrasive sand box of 700 g

Operating air pressure: 5.0 - 8.0 bar

Package: 1 pcs

Weight: 2.2 Kg



Recommended use:



## NOZZLE KIT

Ref. 50205

4 rubber nozzle kit for SUPERMISTRAL ref. 50300, shaped to adhere to internal and external angular surfaces of various shapes.

Compatible with: MISTRAL ref. 50301

Package: 1 kit

Weight: 140 g



Recommended use:



## ABRASIVE SAND

25 Kg abrasive sand package - bags - 1 pcs Ref. 50228

700 g abrasive sand package - jar - 5 pcs. Ref. 50226



# GUNS FOR PROTECTIVE and SEALANT COMPOUNDS

Spray guns conceived to apply loose spray sealants, soundproofing products and car underbody protective products in general; prepackaged cartridge or bagged silicon; plaster and putty, also suited for construction or industrial use. Featuring low air consumption that permits its use in various sectors, the range has been redesigned over the years to meet the various market needs with the addition of new versions (TS/N – PSP) and improving others (IM BODY regulator, PB-PB/S body).



**IM BODY**

Ref. 50242

Gun for protective soundproofing applications for under body, single components and protective wax, equipped with flow regulator and inlet air flow regulator.

Body: nickel-plated sanded brass

Nozzle: 1 short nozzle with fan-3 different types of atomising nozzles with 90 cm extensions

Tank: in anodised aluminium with internal thread cartridge holder and aluminium suction tube

Operating air pressure: 5.0 - 8.0 bar

Cup's capacity: 1 lt

Package: 1 pcs

Weight: 2.1 Kg



Recommended use:



**PB/S**

Ref. 50254

Gun for applying mastic, fillers and silicone products in bags equipped with 3 different shaped nickel-plated brass nozzles.

Body: in polypropylene

Tank: in aluminium with automatic pressure release

Operating air pressure: 2.0 - 5.0 bar Bags: L 34 cm,

Package: 1 pcs

Weight: 1.4 Kg

diam. min Ø 40

diam. max Ø 50



Recommended use:



**PB**

Ref. 50253

Gun for applying mastics, fillers and silicone products in cartridges.

Body: in polypropylene

Tank: in aluminium with automatic pressure release

Operating air pressure: 2.0 - 5.0 bar Cartridge: L 22.5 cm,

Package: 1 pcs

Weight: 1.02 Kg

diam. min Ø 40

diam. max Ø 50



Recommended use:



**AR**

Ref. 50243

Gun for applying single component and two component soundproofing protective compounds, premixed including polyurethane-based compounds or loose.

Bayonet suction cup: aluminium 1000 cc

Body: polished and nickel-plated metal with soft-touch rubber overprinting

Operating air pressure: 2.0 - 5.0 bar

Package: 1 pcs

Weight: 865 g



Recommended use:



## TS

Gun for applying single component soundproofing protective compounds including polyurethane-based compounds and protective waxes in pre-packed 1 lt tins.  
Body: polished and nickel-plated metal with soft-touch rubber overprinting  
Featuring: 60 cm long extension tube with special nozzle for spraying in box

Connector:	
with European thread	(Ref. 50244)
with USA thread	(Ref. 50245)
with Southamerican thread	(Ref. 50244AM)

Operating air pressure: 2.0 - 5.0 bar  
Package: 1 pcs  
Weight: 540 g



Recommended use:



## TS/N

Gun for applying single component soundproofing protective compounds pre-mixed including polyurethane-based compounds or loose.

Body: nylon  
Featuring: 60 cm. long extension tube with special nozzle for spraying in box sections

Nozzle: interior in steel-external in hostaform C®

Connector:	
with European thread	(Ref. 50247)
with USA thread	(Ref. 50247 USA)
with Southamerican thread	(Ref. 50247 AM)

Operating air pressure: 2.0 - 5.0 bar  
Package: 1 pcs  
Weight: 290 g



Recommended use:



## NOZZLE

Ref. 0920901

Hostaform C® connection with adjustable nozzle. Spare part for TS/N

Package: 1 pcs  
Weight: 30 g



Recommended use:



## PSP

Ref. 50246

Gun for the applicatoin of polyurethane foam

Body: nickel-plated brass  
Adapter: universal type for cylinder  
Barrel: 300 mm

Package: 1 pcs  
Weight: 368 g



Recommended use:



# GREASE GUNS

Designed for the high pressure greasing of joints, bearings and gears in general, for the motor vehicle repair sector and for internal machine tool mechanisms in the industrial sector.





**GR/1**

Ref. 50270

High pressure grease gun for loose products.  
 Body: sanded aluminium  
 Delivery: 600 bar  
 Featuring: special 4-claw "ZERK" head;  
 "THE CALAMIT" head;  
 high pressure tube included.

Operating air pressure: 4.0 - 5.0 bar  
 Package: 1 pcs  
 Weight: 3.2 Kg



Recommended use:



**GR/C**

Ref. 50271

High pressure grease gun for products in 600 cc cartridge  
 Body: sanded aluminium  
 Delivery: 600 bar  
 Featuring: special 4-claw "ZERK" head; Cartridge: 600 cc  
 "THE CALAMIT" head; diam. Ø 56  
 high pressure tube included.

Operating air pressure: 4.0 - 5.0 bar  
 Package: 1 pcs  
 Weight: 3.1 Kg



Recommended use:



**GR/E**

Ref. 62006/B

High pressure grease gun for products in cartridge.  
 Body: polished aluminium  
 High pressure hose Cartridge: 400 cc  
 diam. Ø 53

Operating air pressure: 2.0 - 10 bar  
 Package: 1 pcs  
 Weight: 1.5 Kg



Recommended use:



**HEAD**

Ref. 50274

Special 4-claw "ZERK" head.  
 Package: 3 pcs  
 Weight: 110 g



**HEAD**

Ref. 50276

"THE CALAMIT" head.  
 Package: 3 pcs  
 Weight: 120 g



**HOSE**

Ref. 50280

Rubber high pressure hose (max 900 bar) to 40 cm  
 Thread: 10x1 mm  
 Package: 1 pcs  
 Weight: 120 g



# VACUUM CLEANER

Multifunctional product particularly suitable for cleaning inside motor vehicles and therefore ideal for garages, bodyshops and D.I.Y. Compact dimensions, light weight and easy to handle.



**EOLO**  
Ref. 50150

## EOLO

Ref. 50150

Vacuum gun for car interior cleaning. Includes a large nozzle and vacuum rod.  
Can also be used as a blow gun by removing the hose and bag.

Body: sanded aluminium  
Hose length: 50 cm  
Zipped dust bag

Operating air pressure: 4.0 - 8.0 bar  
Package: 1 pcs  
Weight: 530 g



Recommended use:



## EOLO KIT

Ref. 50155

Accessory Kit for EOLO.

Composing:

- 1 wide tool
- 1 suction lance

Operating air pressure: 4.0 - 8.0 bar  
Package: 1 pcs  
Weight: 80 g



Recommended use:



# PNEUMATIC TOOLS

A range that includes the most common pneumatic tools on the market.

Sturdy and reliable, they can be used by DIY and professional with an extremely attractive quality/price ratio. The metallic blue finish sets them apart from "similar" retail articles.

In order to meet the needs of the various customer types, the product has been packaged in two different ways: blister for supermarket and display sales; hard suitcase case for professionals.



## MI

Ref. 62000

Air impact wrench 1/2"  
Body: polished aluminium  
Fitting: 1/4"  
Max torque: 340 Nm  
Speed: 7000 rpm  
Featuring: D connection

Operating air pressure: 6.2 bar  
Package: 1 pcs  
Weight: 2.3 Kg



Recommended use:



## MK

Ref. 62005

Pneumatic ratchet wrench 1/2"  
Body: polished aluminium  
Fitting: 1/4"  
Square drive: 1/2"  
Speed: 150 rpm  
Featuring: D connection

Operating air pressure: 6.2 bar  
Package: 1 pcs  
Weight: 1.27 Kg



Recommended use:



## MS

Ref. 62002

Air hammer  
Body: polished aluminium  
Fitting: 1/4"  
Blows/min: 3500 - 5000  
Featuring: D connection; 4 tips + springs set

Operating air pressure: 6.2 bar  
Package: 1 pcs  
Weight: 1.6 Kg



Recommended use:



## MT

Ref. 62004

Reversible air drill 3/8"  
Body: polished aluminium  
Fitting: 1/4"  
Speed: 1800 rpm  
Featuring: D connection plus wrench

Operating air pressure: 6.2 bar  
Package: 1 pcs  
Weight: 1.02 Kg



Recommended use:



**SET OF 4 TIPS + SPRINGS** Ref. 62003/B

Steel tips for air hammer

Package: 1 pcs  
Weight: 520 Kg



**SET OF 10 HEXAGONAL SLEEVES 1/2"** Ref. 62001/B

Steel sleeves for air impact wrench  
Sizes: 10 - 11- 13- 14 - 17 - 19 - 21 - 22 - 24 - 27

Package: 1 pcs  
Weight: 1.45 Kg



**BOTTLE OF OIL** Ref. 62008/B

For a correct usage of the pneumatic tools

Package: 1 pcs  
Weight: 132 g



# COUPLINGS and PLUGS

**X300 U**

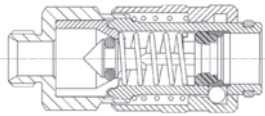

**X300 U**  
universal automatic coupling

Body: nickel-plated brass/aluminium  
Tip: PA66 loaded glass with aluminium ring  
Air valve: brass  
Lock: 6-ball steel  
Gaskets: NBR

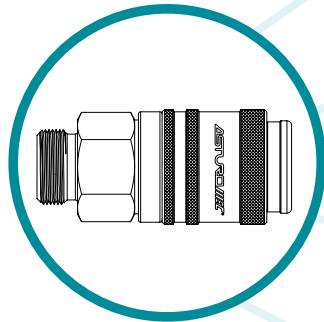

COMPATIBLE PLUGS

STANDARD

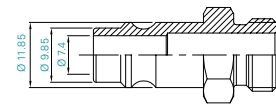

**D**

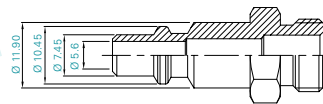

**I**

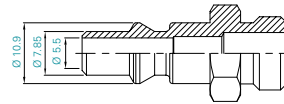

**S**

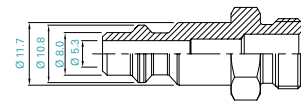

**USA**

**X300**

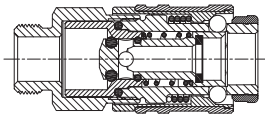

**X300**  
automatic coupling

Body: nickel-plated brass/anodised aluminium  
Tip: PA66 loaded glass with aluminium ring  
Air valve: brass  
Lock: 6-ball steel  
Gaskets: NBR

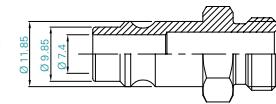
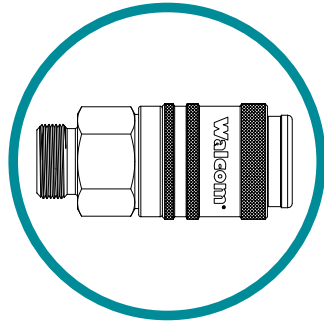

**D**

**X400 AUT**

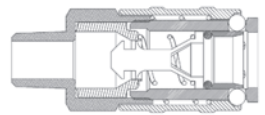

**X400**  
semi-automatic coupling

Body: nickel-plated brass/tempered and chrome-plated steel  
Tip: nickel-plated brass  
Air valve: tropicalized steel  
Lock: 4-ball steel  
Gaskets: NBR

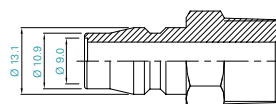
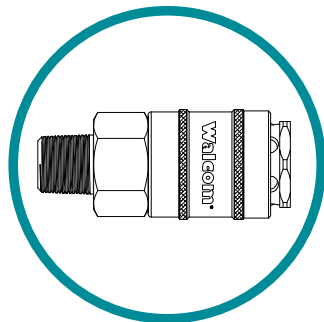

**Jp**

**TECHNICAL SPECIFICATIONS:**

Professional coupling and plugs and high air flow fittings for bodywork use. Japanese (diam. 9.2 mm) and German (diam. 7.4 mm) standards guarantee constant air flow between hose and spray gun, without choking, and air flow over 1.500 l/min at 6 bar.

Operating air pressure: 0 - 16 bar  
Working temperature: -40°C + 80°C

- Standard D
- Standard I
- Standard S
- Standard USA
- Standard X400 AUT

**QUICK COUPLING FLOW DIAGRAM WITH 1 bar**

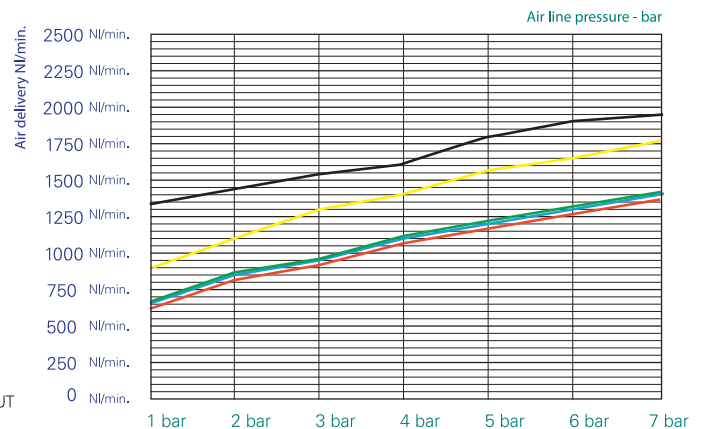

### X300 U - Male

Thread 1/4"	Ref. 10201U
Thread 3/8"	Ref. 10202U
Thread 1/2"	Ref. 10203U

Package: 25 pcs

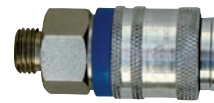

### X300 U - Female

Thread 1/4"	Ref. 10211U
Thread 3/8"	Ref. 10212U
Thread 1/2"	Ref. 10213U

Package: 25 pcs



### X300 U - With rest

Internal diameter 6 mm	Ref. 10221U
Internal diameter 8 mm	Ref. 10222U
Internal diameter 10 mm	Ref. 10223U

Package: 25 pcs



### X300 U - For rubber hose

Internal diameter 6 mm - External diameter 14 mm	Ref. 10231U
Internal diameter 8 mm - External diameter 17 mm	Ref. 10232U
Internal diameter 10 mm - External diameter 19 mm	Ref. 10233U
Internal diameter 8 mm - External diameter 14 mm	Ref. 10234U

Package: 25 pcs



### X300 U - For nylon hose with spring

Thread 6x8	Ref. 10241U
Thread 8x10	Ref. 10242U
Thread 6x10	Ref. 10243U
Thread 8x12	Ref. 10244U
Thread 10x12	Ref. 10246U

Package: 25 pcs



### X300 - Male

Thread 1/4"	Ref. 10251
Thread 3/8"	Ref. 10252
Thread 1/2"	Ref. 10253
Package: 10 pcs	

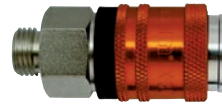

### X300 - Female

Thread 1/4"	Ref. 10261
Thread 3/8"	Ref. 10262
Thread 1/2"	Ref. 10263
Package: 10 pcs	

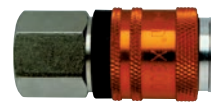

### X300 - With rest

Internal diameter 6 mm	Ref. 10271
Internal diameter 8 mm	Ref. 10272
Internal diameter 10 mm	Ref. 10273
Package: 10 pcs	



### X300 - For rubber hose

Internal diameter 6 mm - External diameter 14 mm	Ref. 10281
Internal diameter 8 mm - External diameter 14 mm	Ref. 10282
Internal diameter 8 mm - External diameter 17 mm	Ref. 10283
Internal diameter 10 mm - External diameter 19 mm	Ref. 10284
Package: 10 pcs	



### X300 - For nylon hose with spring

Thread 6x8	Ref. 10291
Thread 8x10	Ref. 10292
Thread 6x10	Ref. 10293
Thread 8x12	Ref. 10294
Thread 10x12	Ref. 10295
Package: 10 pcs	





### X400 - Male

Thread 1/4"U	Ref. 10551
--------------	------------

Thread 3/8"U	Ref. 10552
--------------	------------

Package: 10 pcs



### X400 - Female

Thread 1/4"U	Ref. 10651
--------------	------------

Thread 3/8"U	Ref. 10652
--------------	------------

Package: 10 pcs



### X400 - With rest

Internal diameter 8 mm	Ref. 10555
------------------------	------------

Internal diameter 10 mm	Ref. 10556
-------------------------	------------

Package: 10 pcs



### X400 - Jp male plug

Thread 1/4"U	Ref. 11470
--------------	------------

Thread 3/8"U	Ref. 11471
--------------	------------

Package: 10 pcs



### X400 - Jp female plug

Thread 1/4"U	Ref. 11480
--------------	------------

Thread 3/8"U	Ref. 11481
--------------	------------

Package: 10 pcs



# X100 S

## Male

Ref. I	Thread	Ref. S	Thread	Ref. USA	Thread	Ref. GB	Thread
10501/S	1/4"	10511/S	1/4"	10521/S	1/4"	10531/S	1/4"
10502/S	3/8"	10512/S	3/8"	10522/S	3/8"	10532/S	3/8"
10503/S	1/2"	10513/S	1/2"	10523/S	1/2"	/	/



Package: 25 pcs

## Female

Ref. I	Thread	Ref. S	Thread	Ref. USA	Thread	Ref. GB	Thread
10601/S	1/4"	10611/S	1/4"	10621/S	1/4"	10631/S	1/4"
10602/S	3/8"	10612/S	3/8"	10622/S	3/8"	10632/S	3/8"



Package: 25 pcs

## For rubber hose

Ref. I	Ø int. - Ø ext.	Ref. S	Ø int. - Ø ext.	Ref. USA	Ø int. - Ø ext.	Ref. GB	Ø int. - Ø ext.
10703/S	6x14	/	/	/	/	/	/
10710/S	8x14	/	/	/	/	/	/
10707/S	8x17	/	/	/	/	/	/
10709/S	10x19	/	/	/	/	/	/



Package: 25 pcs

## For nylon hose with spring

Ref. I	Ø int. - Ø ext.	Ref. S	Ø int. - Ø ext.	Ref. USA	Ø int. - Ø ext.	Ref. GB	Ø int. - Ø ext.
10801/S	6x8	10811/S	6x8	/	/	/	/
10802/S	8x10	10812/S	8x10	10822/S	8x10	/	/
10803/S	8x12	/	/	/	/	/	/



Package: 25 pcs

## With rest

Ref. I	Ø int.	Ref. S	Ø int. - Ø ext.	Ref. USA	Ø int. - Ø ext.	Ref. GB	Ø int. - Ø ext.
/	/	10731/S	6	10741/S	6	10750/S	6
/	/	10733/S	8	10743/S	8	10751/S	8
/	/	/	/	10744/S	9	10752/S	9
/	/	10735/S	10	10745/S	10	/	/
/	/	/	/	10748/S	13	/	/



Package: 25 pcs

# X90

## Couplings

Ref.	Thread	<b>MALE</b> 
10400	1/8"	
10401	1/4"	

Package: 25 pcs

Ref.	Thread	<b>FEMALE</b> 
10410	1/8"	
10411	1/4"	

Package: 25 pcs

Ref.	Ø int.	<b>WITH REST</b> 
10420	6	
10421	8	

Package: 25 pcs

## Plugs

Ref.	Thread	<b>MALE</b> 
11400	1/8"	
11401	1/4"	

Package: 25 pcs

Ref.	Thread	<b>FEMALE</b> 
11410	1/8"	
11411	1/4"	

Package: 25 pcs

Ref.	Ø int.	<b>WITH REST</b> 
11420	6	

Package: 25 pcs

# STEEL PLUGS FOR X100 S and X300 U

## Male

Ref. I	Thread	Ref. S	Thread	Ref. USA	Thread	Ref. GB	Thread
11001	1/4"	11011	1/4"	11021	1/4"	11031	1/4"
11002	3/8"	11012	3/8"	11022	3/8"	/	/
11003	1/2"	11013	1/2"	11023	1/2"	/	/



Package: 25 pcs

## Female

Ref. I	Thread	Ref. S	Thread	Ref. USA	Thread	Ref. GB	Thread
11101	1/4"	11111	1/4"	11121	1/4"	11131	1/4"
11102	3/8"	11112	3/8"	11122	3/8"	11132	3/8"



Package: 25 pcs

## For rubber hose

Ref. I	Ø int. - Ø ext.	Ref. S	Ø int. - Ø ext.	Ref. USA	Ø int. - Ø ext.	Ref. GB	Ø int. - Ø ext.
11170	6x10	/	/	/	/	/	/
11183	6x14	/	/	/	/	/	/
11171	8x12	/	/	/	/	/	/
11190	8x14	/	/	/	/	/	/
11187	8x17	/	/	/	/	/	/
11172	10x15	/	/	/	/	/	/
11188	10x17	/	/	/	/	/	/
11189	10x19	/	/	/	/	/	/



Package: 25 pcs

## Bayonet

Ref. I	/	Ref. S	/	Ref. USA	/	Ref. GB	/
11260	/	/	/	11262	/	/	/



Package: 25 pcs

## For rubber hose with spring

Ref. I	Ø int. - Ø ext.	Ref. S	Ø int. - Ø ext.	Ref. USA	Ø int. - Ø ext.	Ref. GB	Ø int. - Ø ext.
/	/	/	/	11220	4x6	/	/
11201	6x8	11211	6x8	11221	6x8	/	/
11202	8x10	/	/	/	/	/	/
11206	6x10	/	/	/	/	/	/
11204	8x12	/	/	/	/	/	/
11205	10x12	/	/	/	/	/	/



Package: 25 pcs

## With rest

Ref. I	Ø int.	Ref. S	Ø int.	Ref. USA	Ø int.	Ref. GB	Ø int.
/	/	/	/	/	/	/	/
/	/	11301	6	11311	6	/	/
/	/	11303	8	11313	8	/	/
/	/	11304	10	11314	10	/	/
/	/	11305	11	11315	11	11322	11
/	/	11306	12	/	/	/	/



Package: 25 pcs

# STEEL PLUGS ONLY FOR X300 U and X300

## Male

Ref. D	Thread
11041	1/4"
11042	3/8"
11043	1/2"

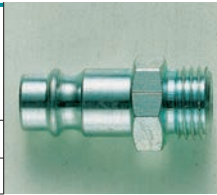

Package: 25 pcs

## Female

Ref. D	Thread
11141	1/4"
11142	3/8"



Package: 25 pcs

## For rubber hose

Ref. D	Ø int. - Ø ext.
11198	6x14
11197	8x14
11199	8x17



Package: 25 pcs

## For rubber hose with spring

Ref. D	Ø int. - Ø ext.
11241	6x8
11242	8x10
11243	6x10
11244	8x12
11245	10x12



Package: 25 pcs

## With rest

Ref. D	Ø int.
11340	5
11341	6
11342	7
11343	8
11344	10
11345	11
11346	12
11347	13



Package: 25 pcs

# FITTINGS

Connections, fittings and accessories for pneumatics made of high quality brass.

PAY ATTENTION TO THE FF SYMBOL that indicates the steel swiveling connections which prevent pipe distortion during their operation, max pressure 10 bar.

Designed with the exclusive assembly system by means of stainless steel snap rings and Buna-N O-RINGS positioned on the exterior of the air passage outlet which allow an air flow with no need for narrowing and with an excellent seal.

## COUPLINGS

### Male sliding cock

Ref.	Thread
12341	1/4"

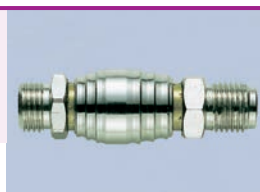

Package: 25 pcs

### Male drain cock

Ref.	Thread
12370	1/8"
12371	1/4"
12372	3/8"
12373	1/2"



Package: 25 pcs

## CONNECTIONS

### Bayonet female

Ref.	Thread
13000	1/8"
13001	1/4"
13002	3/8"



Package: 25 pcs

### Bayonet with rest

Ref.	Ø int. hose
13060	6
13061	7
13062	8



Package: 25 pcs

### Bayonet male

Ref.	Thread
13010	1/8"
13011	1/4"
13012	3/8"



Package: 25 pcs

### Swiveling bayonet connection for rilsan or nylon hose

Ref.	Ø int. - Ø ext.
13090	4x6
13091	6x8
13092	8x10
13093	10x12

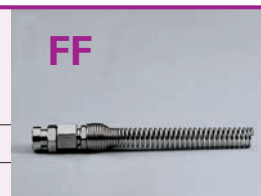

**FF**

Package: 25 pcs

### Bayonet for rubber hose

Ref.	Ø int. - Ø ext.
13023	6x14
13033	8x14
13027	8x17
13028	10x17
13029	10x19



Package: 25 pcs

### Female for rubber hose

Ref.	Thread	Ø int. - Ø ext.
13106	1/4"	6x14
13115	1/4"	8x14
13110	1/4"	8x17
13114	3/8"	6x14
13119	3/8"	8x14
13116	3/8"	8x17



Package: 25 pcs

**Male for rubber hose**

Ref.	Thread	Ø int.-Ø ext.
13133	1/8"	8x17
13136	1/4"	6x14
13143	1/4"	8x14
13140	1/4"	8x17
13144	3/8"	6x14
13149	3/8"	8x14
13146	3/8"	8x17



Package: 25 pcs

**Swiveling female connection for rilsan or nylon hose**

Ref.	Thread	Ø int.-Ø ext.
13220	1/4"	4x6
13221	1/4"	6x8
13222	1/4"	8x10
13223	3/8"	6x8
13224	3/8"	8x10
13225	3/8"	10x12



FF  
Package: 25 pcs

**Fixed bayonet for nylon or rilsan hose**

Ref.	Ø int.-Ø ext.
13180	4x6
13181	6x8
13182	8x10
13183	10x12



Package: 25 pcs

**Swiveling female for polyurethane hose**

Ref.	Thread	Ø int.-Ø ext.
13190	1/4"	5x8
13191	1/4"	6x10
13192	1/4"	6.5x10
13193	1/4"	8x12
13194	1/4"	10x15



FF  
Package: 25 pcs

**Fixed male with rest for every type of hose**

Ref.	Thread	Ø int. hose
13231	1/8"	6
13232	1/8"	7
13250	1/8"	8
13251	1/8"	9
13233	1/4"	5
13234	1/4"	6
13235	1/4"	7
13236	1/4"	8
13237	1/4"	9
13253	1/4"	10
13254	1/4"	15
13238	1/4"	11
13239	3/8"	8
13240	3/8"	9
13256	3/8"	10
13257	3/8"	12
13258	3/8"	13
13247	3/8"	14
13248	3/8"	16
13242	1/2"	11
13243	1/2"	12
13244	1/2"	15
13245	1/2"	17
13246	1/2"	19



Package: 25 pcs

**Fixed female with rest for every type of hose**

Ref.	Thread	Ø int. hose
13260	1/8"	5
13261	1/4"	5
13262	1/4"	6
13263	1/4"	7
13264	1/4"	8
13265	1/4"	9-10
13266	3/8"	7
13267	3/8"	8
13268	3/8"	9-10
13269	3/8"	11
13271	1/2"	12



Package: 25 pcs

**Double rest**

Ref.	Ø int.-Ø ext.
13300	5
13301	6
13303	8
13304	9-10
13305	11



Package: 25 pcs

**Swiveling male for polyurethane hose**

Ref.	Thread	Ø int.-Ø ext.	FF
13311	1/4"	5x8	 Package: 25 pcs
13312	1/4"	6.5x10	
13326	1/4"	6x10	
13327	1/4"	8x12	
13315	3/8"	8x12	
13316	1/2"	9x12	
13317	1/2"	10x16	

**Fixed male for nylon or rilsan hose**

Ref.	Thread	Ø int.-Ø ext.
13200	1/4"	4x6
13201	1/4"	6x8
13202	1/4"	8x10
13204	3/8"	8x10
13205	3/8"	10x12

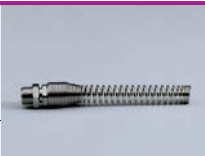

Package: 25 pcs

**Swiveling male for nylon or rubber hose**

Ref.	Thread	Ø int.-Ø ext.	FF
13210	1/4"	4x6	 Package: 25 pcs
13211	1/4"	6x8	
13212	1/4"	8x10	
13213	3/8"	6x8	
13214	3/8"	8x10	
13215	3/8"	10x12	
13216	1/2"	12x15	
13208	3/8"	9x12	
13209	3/8"	11x14	
13217	1/2"	15x20	

**Swiveling male with rest for every type of hose**

Ref.	Thread	Ø int. hose	FF
13330	1/4"	6	 Package: 25 pcs
13331	1/4"	7	
13332	1/4"	8	
13333	1/4"	9	
13334	1/4"	10	
13335	1/4"	11	
13336	3/8"	6	
13337	3/8"	8	
13338	3/8"	9	
13339	3/8"	10	
13340	3/8"	11	
13341	3/8"	12	
13342	3/8"	13	

**Swiveling female with rest for every type of hose**

Ref.	Thread	Ø int. hose	FF
13360	1/4"	6	 Package: 25 pcs
13361	1/4"	7	
13362	1/4"	8	
13363	1/4"	9	
13364	1/4"	10	
13365	3/8"	6	
13366	3/8"	7	
13367	3/8"	8	
13368	3/8"	9	
13369	3/8"	10	



# FITTINGS

## Milled nut

Ref.	Thread
14000	1/4"
14001	14x1.25
14002	3/8"



Package: 25 pcs

## Female with milled nut

Ref.	Thread
14010	1/4"
14011	3/8"



Package: 25 pcs

## Male with milled nut

Ref.	Thread
14021	1/4"
14022	3/8"



Package: 25 pcs

## Double with milled nut

Ref.	Thread
14030	1/4"



Package: 25 pcs

## T with milled nuts

Ref.	Thread
14040	1/4"



Package: 25 pcs

## Cylindrical plug

Ref.	Thread
14250	1/8"
14251	1/4"
14252	3/8"
14253	1/2"
14254	3/4"



Package: 25 pcs

## Cylindrical nipple

Ref.	Thread
14100	1/8" - 1/8"
14101	1/4" - 1/4"
14102	3/8" - 3/8"
14103	1/2" - 1/2"
14104	1/8" - 1/4"
14105	1/8" - 3/8"
14107	1/4" - 3/8"
14108	1/4" - 1/2"
14109	3/8" - 1/2"
14110	1/2" - 3/4"
14111	3/4" - 3/4"

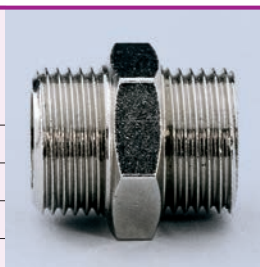

Package: 25 pcs

## Conical nipple

Ref.	Thread
14130	1/8" - 1/8"
14131	1/4" - 1/4"
14132	3/8" - 3/8"
14133	1/2" - 1/2"
14134	1/8" - 1/4"
14135	1/8" - 3/8"
14136	1/4" - 1/2"
14137	1/4" - 3/8"
14138	3/8" - 1/2"
14139	1/2" - 3/4"



Package: 25 pcs

**Cylindrical reduction**

Ref.	Thread
14140	M 1/4" - F 1/8"
14141	M 3/8" - F 1/8"
14142	M 3/8" - F 1/4"
14143	M 1/2" - F 3/8"
14144	M 1/2" - F 1/4"
14145	M 3/4" - F 1/2"
14146	M 3/4" - F 3/8"
14147	M 1/2" - F 1/8"



Package: 25 pcs

**Conical reduction**

Ref.	Thread
14150	M 1/4" - F 1/8"
14151	M 3/8" - F 1/8"
14152	M 3/8" - F 1/4"
14153	M 1/2" - F 3/8"
14154	M 1/2" - F 1/4"
14155	M 3/4" - F 1/2"
14156	M 3/4" - F 3/8"



Package: 25 pcs

**Extension**

Ref.	Thread
14170	M 1/8" - F 1/8"
14171	M 1/8" - F 1/4"
14172	M 1/8" - F 3/8"
14174	M 1/4" - F 1/8"
14175	M 1/4" - F 1/4"
14176	M 1/4" - F 3/8"
14179	M 3/8" - F 1/4"
14180	M 3/8" - F 3/8"
14181	M 3/8" - F 1/2"
14184	M 1/2" - F 3/8"
14185	M 1/2" - F 1/2"



Package: 25 pcs

**Double female**

Ref.	Thread
14200	1/8" - 1/8"
14201	1/4" - 1/4"
14202	3/8" - 3/8"
14203	1/2" - 1/2"
14204	1/8" - 1/4"
14205	1/8" - 3/8"
14206	1/2" - 1/8"
14207	1/4" - 3/8"
14208	1/4" - 1/2"
14209	3/8" - 1/2"



Package: 25 pcs

**L male/female**

Ref.	Thread
14300	1/8"
14301	1/4"
14302	3/8"
14303	1/2"



Package: 25 pcs

**T female/male/female**

Ref.	Thread
14340	1/8"
14341	1/4"
14342	3/8"
14343	1/2"



Package: 25 pcs

**L female/female**

Ref.	Thread
14310	1/8"
14311	1/4"
14312	3/8"
14313	1/2"



Package: 25 pcs

**T female/female/female**

Ref.	Thread
14350	1/8"
14351	1/4"
14352	3/8"
14353	1/2"



Package: 25 pcs

**L male/male**

Ref.	Thread
14315	1/8"
14316	1/4"
14317	3/8"
14318	1/2"



Package: 25 pcs

**T female/female/male**

Ref.	Thread
14355	1/8"
14356	1/4"
14357	3/8"
14358	1/2"



Package: 25 pcs

**Y female/male/female**

Ref.	Thread
14320	1/8"
14321	1/4"
14322	3/8"
14323	1/2"



Package: 25 pcs

**T male/male/male**

Ref.	Thread
14360	1/8"
14361	1/4"
14362	3/8"
14363	1/2"



Package: 25 pcs

**Y female/female/female**

Ref.	Thread
14330	1/8"
14331	1/4"
14332	3/8"
14333	1/2"



Package: 25 pcs

**Cross F.F.F.M.**

Ref.	Thread
14370	1/8"
14371	1/4"
14372	3/8"
14373	1/2"



Package: 25 pcs

**Cross M.M.M.M**

Ref.	Thread
14375	1/8"
14376	1/4"
14377	3/8"
14378	1/2"

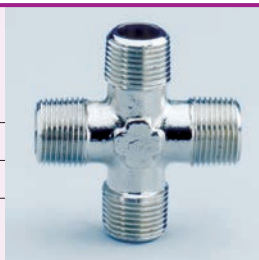

Package: 25 pcs

**Cross F.F.F.F.**

Ref.	Thread
14380	1/8"
14381	1/4"
14382	3/8"
14383	1/2"



Package: 25 pcs

**Male quick plug "D" with milled nut**

Ref.	Thread
11045	1/4"



Package: 25 pcs

**Bayonet seals**

Ref.
60920



Package: 100 pcs

# ACCESSORIES FOR PNEUMATIC

## NEEDLE AIR LINE TAPS

### Male with milled nut

Ref.	Thread
12010	1/4"
12011	3/8"
12012	1/2"

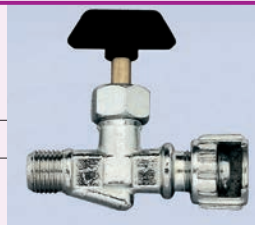

Package: 25 pcs

## MINI BALL VALVES

### Male with milled nut

Ref.	Thread
12110	1/4"
12111	3/8"



Package: 25 pcs

### Male/Male

Ref.	Thread
12131	1/4"
12132	3/8"



Package: 25 pcs

### Female/Female

Ref.	Thread
12150	1/8"
12151	1/4"
12152	3/8"
12153	1/2"



Package: 25 pcs

### Male/ Female

Ref.	Thread
12170	1/8"
12171	1/4"
12172	3/8"
12173	1/2"



Package: 25 pcs

# QUICK FITTINGS

## Cylindrical male

Ref.	Thread	Ø int. - Ø ext.
15000	1/8"	4x6
15001	1/4"	4x6
15002	1/8"	6x8
15003	1/4"	6x8
15006	1/4"	8x10
15007	3/8"	8x10
15009	3/8"	10x12



Package: 25 pcs

## Straight

Ref.	Ø int. - Ø ext.
15070	4x6
15071	6x8
15072	8x10
15073	10x12



Package: 25 pcs

## L male

Ref.	Thread	Ø int. - Ø ext.
15090	1/8"	4x6
15093	1/4"	6x8
15096	1/4"	8x10
15098	1/2"	8x10
15099	3/8"	10x12



Package: 25 pcs

## L female

Ref.	Thread	Ø int. - Ø ext.
15121	1/4"	6x8



Package: 25 pcs

## Elbow

Ref.	Ø hose
15140	4x6
15141	6x8
15142	8x10
15143	10x12



Package: 25 pcs

## T central male

Ref.	Thread	Ø hose
15160	1/8"	4x6
15162	1/8"	6x8
15163	1/4"	6x8
15164	3/8"	6x8
15165	1/8"	8x10
15166	1/4"	8x10
15169	3/8"	10x12



Package: 25 pcs

## T EE

Ref.	Ø int. - Ø ext.
15180	4x6
15181	6x8
15182	8x10
15183	10x12



Package: 25 pcs

## Blocking nut

Ref.	Ø hose
15400	4x6
15401	6x8
15402	8x10
15403	10x12



Package: 25 pcs

# CONNECTIONS WITH FERRULES

## Conical male

Ref.	Thread	Ø ext. hose
16000	1/8"	6
16001	1/4"	6
16002	1/8"	8
16003	1/4"	8
16004	3/8"	8
16005	1/4"	10
16006	3/8"	10
16007	3/8"	12



Package: 25 pcs

## Straight

Ref.	Ø ext. hose
16040	6
16041	8
16042	10
16043	12



Package: 25 pcs

## L male

Ref.	Thread	Ø ext. hose
16060	1/8"	6
16061	1/4"	6
16062	1/8"	8
16063	1/4"	8
16064	3/8"	8
16065	1/4"	10
16066	3/8"	10
16067	3/8"	12
16068	1/2"	12



Package: 25 pcs

## T central male

Ref.	Thread	Ø ext. hose
16120	1/8"	6
16121	1/4"	6
16122	1/8"	8
16123	1/4"	8
16124	3/8"	8
16125	1/4"	10
16126	3/8"	10
16127	3/8"	12
16128	1/2"	12



Package: 25 pcs

## Elbow

Ref.	Ø ext. hose
16100	6
16101	8
16102	10
16103	12



Package: 25 pcs

## T EE

Ref.	Ø ext. hose
16160	6
16161	8
16162	10
16163	12



Package: 25 pcs

## Blocking nut

Ref.	Ø ext. hose
16300	6
16301	8
16302	10
16303	12



Package: 25 pcs

## Brass ferrule

Ref.	Ø ext. hose
16320	6
16321	8
16322	10
16323	12



Package: 100 pcs

# AUTOMATIC FITTINGS

## Conical male

Ref.	Thread	Ø ext. hose
17000	1/8"	4
17001	1/8"	6
17002	1/4"	6
17003	1/8"	8
17004	1/4"	8
17005	3/8"	8
17006	1/4"	10
17007	3/8"	10
17008	1/4"	12
17009	3/8"	12



Package: 25 pcs

## Straight

Ref.	Ø ext. hose
17040	4
17041	6
17042	8
17043	10
17044	12



Package: 25 pcs

## L male

Ref.	Thread	Ø ext. hose
17101	1/8"	4
17102	1/8"	6
17104	1/8"	8
17105	1/4"	8
17107	1/4"	10
17108	3/8"	10
17109	1/4"	12
17110	3/8"	12



Package: 25 pcs

## L swiveling male

Ref.	Thread	Ø ext. hose
17130	1/8"	4
17131	1/8"	6
17132	1/4"	6
17133	1/8"	8
17134	1/4"	8
17135	3/8"	8
17136	1/4"	10
17137	3/8"	10
17138	1/4"	12
17139	3/8"	12



Package: 25 pcs

## Elbow

Ref.	Ø ext. hose
17150	4
17151	6
17152	8
17153	10
17154	12



Package: 25 pcs

## Single hollow bolt

Ref.	Thread	Ø ext. hose
17400	M5	4
17401	1/8"	4
17402	1/8"	6
17403	1/4"	6
17404	1/8"	8
17405	1/4"	8
17406	1/4"	10
17407	3/8"	10



Package: 25 pcs

**T central male** \*swiveling

Ref.	Thread	Ø ext. hose
17201	1/8"	4
17202	1/8"	6
17203*	1/4"	6
17204	1/8"	8
17205	1/4"	8
17206*	3/8"	8
17207	1/4"	10
17208	3/8"	10
17209	1/4"	12
17210	3/8"	12



Package: 25 pcs

**Female**

Ref.	Thread	Ø ext. hose
17020	1/8"	4
17021	1/8"	6
17022	1/4"	6
17023	1/8"	8
17024	1/4"	8
17025	1/4"	10



Package: 25 pcs

**T EE**

Ref.	Ø ext. hose
17300	4
17301	6
17302	8
17303	10
17304	12



Package: 25 pcs

**Bulckhead straight**

Ref.	Ø ext. hose
17050	4
17051	6
17052	8
17053	10
17054	12



Package: 25 pcs



# MODULAR FILTERS REGULATORS LUBRICATORS

Ideal for use in bodyshops, mechanical garages and wherever there is need to treat the air and adjust the flow. From simple regulators, filters or lubricators to filter groups for pneumatic installation (filter+lubricator) or spray installations (filter+coalescent microfilter).

## MICROPRESSURE REGULATOR

Membrane micro regulator, equipped with regulation knob with relieving lock.  
Operating air pressure: MAX 16 bar  
Regulator range: 0-8 bar  
Gauge connection: M 1/8"

Diameter air inlet 1/8"	Ref. 61100
Diameter air inlet 1/4"	Ref. 61101

Package: 1 pcs  
Weight: 90 g



Recommended use:



## PRESSURE REGULATOR

Membrane micro regulator, equipped with regulation knob with relieving lock.  
Operating air pressure: MAX 16 bar  
Regulator range: 0-8 bar  
Gauge connection: M 1/8"

Diameter air inlet 1/4" - (*)	Ref. 61111
Diameter air inlet 3/8" - (**)	Ref. 61112
Diameter air inlet 1/2" - (***)	Ref. 61113

Package: 1 pcs  
(\*) Weight: 135 g - (\*\*) Weight: 320 g - (\*\*\*) Weight: 440 g



Recommended use:



## FILTER

Filter with filtering element with 20 micron porosity.  
Special reinforced bowl.  
Max inlet pressure: MAX 16 bar

Diameter air inlet 1/4" - (*)	Ref. 61121
Diameter air inlet 3/8" - (**)	Ref. 61122
Diameter air inlet 1/2" - (***)	Ref. 61123

Package: 1 pcs  
(\*) Weight: 115 g - (\*\*) Weight: 230 g - (\*\*\*) Weight: 355 g



Recommended use:



## FILTER REGULATOR

Membrane regulator filter with 20 micron synthetic filtering element, equipped with regulation knob with relieving lock.  
Special reinforced cup

Operating air pressure: MAX 16 bar  
Regulator range: 0-8 bar  
Gauge connection: M 1/8"

Diameter air inlet 1/4" - (*)	Ref. 61131
Diameter air inlet 3/8" - (**)	Ref. 61132
Diameter air inlet 1/2" - (***)	Ref. 61133

Package: 1 pcs - (\*) Weight: 115 g - (\*\*) Weight: 230 g - (\*\*\*) Weight: 355 g



Recommended use:



## COALESCENT MICROFILTER

Coalescent microfilter.  
Efficiency: 99.9%

Diameter air inlet 1/4" - (*)	Ref. 61201
Diameter air inlet 3/8" - (**)	Ref. 61202
Diameter air inlet 1/2" - (***)	Ref. 61203

Package: 1 pcs  
(\*) Weight: 115 g - (\*\*) Weight: 225 g - (\*\*\*) Weight: 345 g



Recommended use:



## LUBRICATOR

Lubricator working with oil fogging propotional system.  
Special reinforced bowl.  
Max inlet pressure: MAX 16 bar

Diameter air inlet 1/4" - (*)	Ref. 61141
Diameter air inlet 3/8" - (**)	Ref. 61142
Diameter air inlet 1/2" - (***)	Ref. 61143

Package: 1 pcs  
(\*) Weight: 115 g - (\*\*) Weight: 230 g - (\*\*\*) Weight: 360 g



Recommended use:



## FILTER REGULATOR WITH LUBRICATOR

Filter group which associates the features of the filter regulator with those of the lubricator.

Diameter air inlet 1/4" - (*)	Ref. 61151
Diameter air inlet 3/8" - (**)	Ref. 61152
Diameter air inlet 1/2" - (***)	Ref. 61153

Package: 1 pcs  
(\*) Weight: 310 g - (\*\*) Weight: 675 g - (\*\*\*) Weight: 975 g



Recommended use:



## FILTER - REGULATOR - LUBRICATOR

Filter group which associates the features of the filter, the regulator and those of the lubricator.

Diameter air inlet 1/4" - (*)	Ref. 61161
Diameter air inlet 3/8" - (**)	Ref. 61162
Diameter air inlet 1/2" - (***)	Ref. 61163

Package: 1 pcs  
(\*) Weight: 380 g - (\*\*) Weight: 850 g - (\*\*\*) Weight: 1.25 Kg



Recommended use:



## ACCESSORIES

Unit connection kit for 1/8" and 1/4"	Ref. 61190
Unit connection kit for 3/8"	Ref. 61191
Unit connection kit for 1/2"	Ref. 61194
Wall unit connection for 1/8" and 1/4"	Ref. 61192
Wall unit connection for 3/8" and 1/2"	Ref. 61193
Gauge with rear connection 1/8", diameter 40 mm (*)	Ref. 61301

Package: 1 pcs - (\*) 4 pcs

# GAUGE AND AIR COMPRESSED ACCESSORIES

## GAUGE

Ref. 61300

Radial connection - M 1/4"  
Double pressure gauge range 0 - 12 bar / 0 - 170 psi  
Diameter 63 mm

Package: 4 pcs  
Weight: 385 g



## GAUGE

Double pressure gauge range 0 - 12 bar / 0 - 170 psi

Rear connection - M 1/8" - diameter 40 mm (\*) Ref. 61301

Rear connection - M 1/8" - diameter 50 mm (\*\*) Ref. 61302

Rear connection - M 1/4" - diameter 63 mm (\*\*\*) Ref. 61303

Package: 4 pcs  
(\*) Weight: 290 g - (\*\*) Weight: 335 g - (\*\*\*) Weight: 345 g



## GAUGE - CEE

Pressure gauge range 0 - 10 bar (only Ref. 61314 double range 0 - 10 bar / 0 - 140 psi)

Rear connection - M 1/4" - diameter 63 mm (\*) Ref. 61310

Rear connection - M 1/4" - diameter 80 mm (\*\*) Ref. 61311

Rear connection - M 1/4" - diameter 63 mm (\*\*\*) Ref. 61314

Package: 4 pcs - (only Ref. 61311 package 1 pcs)  
(\*) Weight: 405 g - (\*\*) Weight: 230 g - (\*\*\*) Weight: 405 g



## GAUGE

Ref. 61313

Rear connection - M 1/4"  
Double pressure gauge range 0 - 10 bar / 0 - 140 psi  
Diameter 80 mm

Package: 1 pcs  
Weight: 105 g



## MICROPRESSURE REDUCER Ref. 61000

Micropressure reducer.  
Needle air line tap M 1/4"  
Connection: F 1/4"  
Pressure gauge range 0 - 12 bar

Package: 3 pcs  
Weight: 905 g



## PRESSURE REDUCER

Pressure reducer with ceramic filter and gauge.  
Outlet with 2 needle air line taps.

Connection - M 3/8" - pressure gauge range 0 - 12 bar (*)	Ref. 61001
Connection - M 1/2" - pressure gauge range 0 - 16 bar (**)	Ref. 61002
Connection - F 1/2" - pressure gauge range 0 - 12 bar (***)	Ref. 61003

Package: 2 pcs - (only Ref. 61003 package 1 pcs)

(\*) Weight: 1.3 Kg - (\*\*) Weight: 2.1 Kg - (\*\*\*) Weight: 1.2 Kg



## SAFETY VALVE

Model with connection

Connection - M 1/4" - weight: 340 g - package: 5 pcs	Ref. 61050
Connection - M 3/8" - weight: 520 g - package: 5 pcs	Ref. 61051
Connection - M 3/8" - weight: 520 g - package: 5 pcs	*Ref. 61051/CE
Connection - M 1/2" - weight: 440 g - package: 3 pcs	Ref. 61052
Connection - M 1/2" - weight: 440 g - package: 3 pcs	*Ref. 61052/CE
Connection - M 3/4" - weight: 630 g - package: 2 pcs	Ref. 61053
Connection - M 3/4" - weight: 630 g - package: 2 pcs	*Ref. 61053/CE

(\*) Versions at 10 bar with EC approved certificate.



## AIR PRESSURE SWITCH

Air pressure switch with drain valve.

Mini monophase model up to 4 HP - (*)	Ref. 61060
Special mini triphase model up to 5.5 HP - (**)	Ref. 61061

Package: 1 pcs

(\*) weight: 310 g - (\*\*) weight: 605 g



## WITHHOLDING VALVE

Ref. 61065

Horizontal withholding valve with connection for nylon hose  
Connection: F 1/2" - M 3/8"

Package: 5 pcs

Weight: 865 g



# HOSES

Complete and professional air hose range for any type of use, in various lengths and versions. From high performance Polyurethane to flexible Ragno, to efficient Rilsan to the proven and always reliable Nylon, Rubber and PVC; Walmecc presents the new Rubberflex<sub>THT/SR</sub> hose with high performance in terms of sturdiness, durability, seal, flexibility and temperature resistance.

## STRAIGHT POLYURETHANE

### 100 m coil

Substrate and cover: 100% polyurethane  
Reinforcement: 550/1100 Trevira Hoechst polyester yarn  
Operating air pressure: 20 bar - exploding pressure: 60 bar  
Temperature: - 25°C + 60°C

Internal diameter 6 mm - external diameter 10 mm	Ref. 60200
Internal diameter 8 mm - external diameter 12 mm	Ref. 60201
Internal diameter 10 mm - external diameter 14.5 mm	Ref. 60202

Package: 1 pcs



## STRAIGHT POLYURETHANE

### 10 m coil with 2 swiveling female 1/4" fittings

Substrate and cover: 100% polyurethane  
Reinforcement: 550/1100 Trevira Hoechst polyester yarn  
Operating air pressure: 20 bar - exploding pressure: 60 bar  
Temperature: - 25°C + 60°C

Internal diameter 6 mm - external diameter 10 mm	Ref. 60210
Internal diameter 8 mm - external diameter 12 mm	Ref. 60211
Internal diameter 10 mm - external diameter 14.5 mm	Ref. 60212

Package: 1 pcs



## STRAIGHT POLYURETHANE

### 25 m coil with 2 swiveling female 1/4" fittings.

Substrate and cover: 100% polyurethane  
Reinforcement: 550/1100 Trevira Hoechst polyester yarn  
Operating air pressure: 20 bar - exploding pressure: 60 bar  
Temperature: - 25°C + 60°C

Internal diameter 6 mm - external diameter 10 mm	Ref. 60220
Internal diameter 8 mm - external diameter 12 mm	Ref. 60221
Internal diameter 10 mm - external diameter 14.5 mm	Ref. 60222

Package: 1 pcs



## RAGNO HOSE

### 50 m coil

Substrate and cover: polyurethane anti-abrasive and thermoplastic rubber  
Reinforcement: polyester yarn  
Operating air pressure: 20 bar - exploding pressure: 60 bar  
Temperature: - 20°C + 60°C

Internal diameter 10 mm - external diameter 15 mm	Ref. 60250
Internal diameter 8 mm - external diameter 12 mm	Ref. 60254

Package: 1 pcs



## RAGNO HOSE

Ref. 60252

**10 m coil** with fittings

Substrate and cover: polyurethane anti-abrasive and thermoplastic rubber

Reinforcement: polyester yarn

Operating air pressure: 20 bar - exploding pressure: 60 bar

Temperature: - 20°C + 60°C

Internal diameter 10 mm - external diameter 15 mm

Package: 1 pcs



## SUPERFLEX

High performance and resistance hose, PU (Polyurethane) composite and thermoplastic rubber, reinforced with polyester. Antistatic.

**100 m coil**

Bottom layer and cover: PU composite and thermoplastic rubber

Reinforcing: polyester fiber

Operating air pressure: 15 - 20 bar

Exploding pressure: 60 bar

Temperature: - 15°C + 70°C

Internal diameter 10 mm - external diameter 15 mm

Ref. 60307

Package: 1 pcs



## SUPERFLEX

High performance and resistance hose, PU (Polyurethane) composite and thermoplastic rubber, reinforced with polyester. Antistatic.

**12 m coil**

Bottom layer and cover: PU composite and thermoplastic rubber

Reinforcing: polyester fiber

Operating air pressure: 15 - 20 bar

Exploding pressure: 60 bar

Temperature: - 15°C + 70°C

Internal diameter 10 mm - external diameter 15 mm

Ref. 60309

Package: 1 pcs



## POLYURETHANE SPIRAL HOSE

**4 m spiral hose** with one straight extension

Operating air pressure: 20 bar - exploding pressure: 60 bar

Temperature: - 25°C + 60°C

Internal diameter 3.6 mm - external diameter 6 mm

Ref. 60030

Internal diameter 5 mm - external diameter 8 mm

Ref. 60031

Package: 5 pcs



## POLYURETHANE SPIRAL HOSE

**8 m spiral hose** with 2 straight extensions

Operating air pressure: 20 bar - exploding pressure: 60 bar

Temperature: - 25°C + 60°C

Internal diameter 3.6 mm - external diameter 6 mm

Ref. 60040

Internal diameter 5 mm - external diameter 8 mm

Ref. 60041

Internal diameter 6.5 mm - external diameter 10 mm

Ref. 60042

Internal diameter 8 mm - external diameter 12 mm

Ref. 60043

Internal diameter 10 mm - external diameter 16 mm \*

Ref. 60044

Package: 2 pcs - \* Package: 1 pcs



## POLYURETHANE SPIRAL HOSE

**40 m spiral hose** without straight extensions  
 Operating air pressure: 20 bar- exploding pressure: 60 bar  
 Temperature: - 25°C + 60°C

Internal diameter 5 mm - external diameter 8 mm	Ref. 60051
Internal diameter 6.5 mm - external diameter 10 mm	Ref. 60052
Internal diameter 8 mm - external diameter 12 mm	Ref. 60053
Internal diameter 10 mm - external diameter 16 mm	Ref. 60054

Package: 1 pcs



## POLYURETHANE SPIRAL HOSE Ref. 60520

**4 m polyurethane spiral hose** equipped with PROFI blow gun with silenced nozzle meeting EEC regulations (ref. 50006) and 2 swiveling fittings M 1/4" with protective steel springs.

Package: 5 pcs



## RILSAN SPIRAL HOSE

**Rilsan spiral hose**  
 Operating air pressure: 20 bar  
 Basic package: 6 x 8 = 270 m; 8 x 10 = 180 m; 10 x 12 = 120 m

Internal diameter 6 mm - ext 8 mm - length 10 m - 27 pcs	Ref. 60007
Internal diameter 6 mm - ext 8 mm - length 15 m - 18 pcs	Ref. 60008
Internal diameter 6 mm - ext 8 mm - length 30 m - 9 pcs	Ref. 60009
Internal diameter 8 mm - ext 10 mm - length 10 m - 18 pcs	Ref. 60012
Internal diameter 8 mm - ext 10 mm - length 15 m - 12 pcs	Ref. 60013
Internal diameter 8 mm - ext 10 mm - length 30 m - 6 pcs	Ref. 60014
Internal diameter 10 mm - ext 12 mm - length 10 m - 12 pcs	Ref. 60017
Internal diameter 10 mm - ext 12 mm - length 15 m - 8 pcs	Ref. 60018
Internal diameter 10 mm - ext 12 mm - length 30 m - 4 pcs	Ref. 60019



## STRAIGHT RILSAN HOSE

**100 m straight rilsan hose** - Operating air pressure: 20 bar

Internal diameter 4 mm - ext 6 mm	Ref. 60326
Internal diameter 6 mm - ext 8 mm	Ref. 60327
Internal diameter 8 mm - ext 10 mm	Ref. 60328
Internal diameter 10 mm - ext 12 mm	Ref. 60329

Package: 1 pcs



## RUBBER

### 100 m straight rubber hose

Operating air pressure: 20 bar

Internal diameter 6 mm - external diameter 14 mm	Ref. 60300
--	------------

Internal diameter 8 mm - external diameter 17 mm	Ref. 60301
--	------------

Package: 1 pcs



## NYLON

### Plastic coated nylon 6 hose

Operating air pressure: 25 bar

Basic package: 6 x 8=270 m; 8 x 10 =180 m; 10 x 12 =120 m

Internal diameter 6 mm - ext 8 mm - length 10 m - 27 pcs	Ref. 60107
--	------------

Internal diameter 6 mm - ext 8 mm - length 15 m - 18 pcs	Ref. 60108
--	------------

Internal diameter 6 mm - ext 8 mm - length 30 m - 9 pcs	Ref. 60109
---	------------

Internal diameter 8 mm - ext 10 mm - length 10 m - 18 pcs	Ref. 60112
---	------------

Internal diameter 8 mm - ext 10 mm - length 15 m - 12 pcs	Ref. 60113
---	------------

Internal diameter 8 mm - ext 10 mm - length 30 m - 6 pcs	Ref. 60114
--	------------

Internal diameter 10 mm - ext 12 mm - length 10 m - 12 pcs	Ref. 60117
--	------------

Internal diameter 10 mm - ext 12 mm - length 15 m - 8 pcs	Ref. 60118
---	------------

Internal diameter 10 mm - ext 12 mm - length 30 m - 4 pcs	Ref. 60119
---	------------



## PVC

Ref. 60330

### Clear hose in plastified PVC

Operating air pressure: 20 bar

Internal diameter 8 mm - ext 13 mm

Length 100 m

Package: 1 pcs





## PAINT SPRAY GUNS:

# PRIMA

- New conception spray gun for D.I.Y. and not - D.I.Y.
- Body entirely in aluminium
- Ergonomic and functional

- High precision of product and fan regulation
- New anti-solvent sealing gaskets

### PRIMA

(with 680 cc nylon cup) - Ref. 296\*\*

Ideal for all types of paint and for work on any surfaces

Body: polished aluminium

Air cap: nickel-plated zamak

Needle-nozzle: brass

Adjustments: product -fan

Weight: 645 g

Operating air pressure: 2.0 - 3.5 bar

Air consumption: 180 - 280 l/min.

Ø nozzle: 1.2 - 1.5 - 1.7 - 1.8 - 2.0 - 2.5

500 cc aluminium cup version (Weight: 545 g)

Ref. 297\*\*

750 cc aluminium cup version (Weight: 595 g)

Ref. 298\*\*



NOTE:  
add nozzle Ø to Ref. (\*\*)

Recommended use:



### PRIMA

Ref. 295\*\*

Ideal for all types of paint and for work on any surfaces

Bayonet suction cup: aluminium 1000 cc

Body: polished aluminium

Air cap: nickel-plated zamak

Needle-nozzle: brass

Adjustments: product -fan

Weight: 720 g

Operating air pressure: 2.0 - 3.5 bar

Air consumption: 180 - 280 l/min.

Ø nozzle: 1.2 - 1.5 - 1.7 - 1.8 - 2.0 - 2.5



NOTE:  
add nozzle Ø to Ref. (\*\*)

Recommended use:



### SPARE PARTS

Needle-nozzle-air cap for **PRIMA**

Nozzle diameter: 1.2 Ref. 40130

Nozzle diameter: 1.5 Ref. 40131

Nozzle diameter: 1.7 Ref. 40132

Nozzle diameter: 1.8 Ref. 40133

Nozzle diameter: 2.0 Ref. 40134

Nozzle diameter: 2.5 Ref. 40135



Recommended use:



## COMPLETE RANGE OF:

# COMPRESSED AIR GUNS

Blow guns: PA - PA/L  
Washing guns: NE/S - NE

Sandblasting guns: PS/E - PS/ES  
Protective and sealant guns: TS/ES - TS/E

### PA

Ref. 50080

Aluminium blow gun suitable for every use.  
Short nozzle  
Operating air pressure: 1.0 - 6.0 bar

Weight: 2.1 Kg  
Package: 12 pcs



Recommended use:



### PA/L

Ref. 50081

Aluminium blow gun with 150 mm long straight barrel  
Operating air pressure: 1.0 - 6.0 bar

Weight: 1.8 Kg  
Package: 8 pcs



Recommended use:



### NE/S

Ref. 50086

Aluminium washing gun  
Bayonet cup with screw closure: 1000 cc aluminium  
Adjustable liquid atomiser nozzle: brass  
Extra large filler opening - bayonet closure  
Operating air pressure: 2.0 - 8.0 bar

Weight: 920 g  
Package: 2 pcs



Recommended use:



### NE

Ref. 50085

Aluminium washign gun  
Bayonet cup with screw closure: 1000 cc painted steel  
Adjustable liquid atomiser nozzle: brass  
Operating air pressure: 2.0 - 8.0 bar

Weight: 1.1 Kg  
Package: 2 pcs



Recommended use:



**PS/E**

Ref. 50090

Sanblasting gun suitable for medium surfaces.  
 Body: aluminium  
 Nozzle: super-tough cemented steel Ø 6 mm  
 Immersed hoses: 2 m hose - diameter 8x13  
 Operating air pressure: 5.0 - 8.0 bar

Weight: 640 g  
 Package: 1 pcs



Recommended use:



**PS/ES**

Ref. 50091

Sanblasting gun suitable for medium surfaces  
 Bayonet cup with screw closure: 1000 cc aluminium  
 Body: aluminium  
 Nozzle: super-tough cemented steel Ø 6 mm with adjustable sand delivery  
 Operating air pressure: 5.0 - 8.0 bar

Weight: 770 g  
 Package: 1 pcs



Recommended use:



**TS/ES**

Ref. 50096

Gun for applying single component and two component sound-proofing protective compounds, whether pre-mixed including polyurethane-based compounds or loose.  
 Bayonet cup with screw closure: 1000 cc aluminium  
 Body: aluminium  
 Operating air pressure: 2.0 - 5.0 bar

Weight: 670 g  
 Package: 1 pcs



Recommended use:



**TS/E**

Ref. 50095

Gun for applying single component soundproofing protective compounds including polyurethane-based compounds and protective waxes in pre-packed 1 l tins.  
 Body: aluminium with disposable connector in Hostaform C®.  
 Featuring: 60 cm hose extension with special nozzle for box parts  
 Operating air pressure: 2.0 - 5.0 bar

Weight: 220 g  
 Package: 1 pcs



Recommended use:



**NOZZLE**

Ref. 0920901

Hostaform C® connection adjustable. Spare part for TS/E and TS/N.

Weight: 30 g  
 Package: 1 pcs



Recommended use:



# Products available in **BLISTER**

The blister pack programme is an eye-catching and customer-friendly means of presenting the range at the sales point. The products, inside an attractive and understandable blister pack can be displayed on any wall mounting, therefore rationing space and obtaining a notable visible effect which facilitates sales.

## **UR/S PLUS** (with 680 cc nylon cup) - Ref. 27314/B

Gravity feed spray gun  
Ø nozzle: 1.4

Blister dimension: 40x20.5 cm  
Weight: 925 g  
Package: 6 pcs

See features on page 15 - SPRAY GUN section



## **UR PLUS** (with 1000 cc aluminium cup) - Ref. 27017/B

Spray gun with suction feed for every type of spraying  
Ø nozzle: 1.7

Blister dimension: 40x20.5 cm  
Weight: 1.1 Kg  
Package: 6 pcs

See features on page 15 - SPRAY GUN section



## **PRIMA** (with 680 cc nylon cup) - Ref. 29615/B

Gravity feed spray gun ideal for D.I.Y.  
Ø nozzle: 1.5

Blister dimension: 40x20.5 cm  
Weight: 775 g  
Package: 6 pcs

See features on page 92 - HOBBY LINE section



## **PRIMA** (with 1000 cc aluminium cup) - Ref. 29517/B

Gravity feed spray gun ideal for D.I.Y.  
Ø nozzle: 1.7

Blister dimension: 40x20.5 cm  
Weight: 870 g  
Package: 6 pcs

See features on page 92 - HOBBY LINE section



## **ES/RV & DECOR KIT** (with 250 cc nylon cup) - Ref. 34707/B

Mini spray gun for decorations and touch-ups  
Ø nozzle: 0.7  
Standard: 3 glass cup, 20 cc, ES/RV adapter to be screwed onto the body

Blister dimension: 40x20.5 cm  
Weight: 740 g  
Package: 2 pcs

See features on page 17-18 - SPRAY GUN section



**PA**

Ref. 50080/B

Aluminium blow gun suited for any use  
Short nozzle

Blister dimension: 20x20.5 cm  
Weight: 200 g  
Package: 10 pcs

See features on page 93 - HOBBY LINE section



**PA/L**

Ref. 50081/B

Blow gun with aluminium body  
150 mm long barrel

Blister dimension: 20x20.5 cm  
Weight: 250 g  
Package: 10 pcs

See features on page 93 - HOBBY LINE section



**PA/4N**

Ref. 50047/B

Blow gun with nylon body.  
Short nozzle

Blister dimension: 20x20.5 cm  
Weight: 220 g  
Package: 10 pcs

See features on page 42 - COMPRESSED AIR GUNS section



**PA/4NL**

Ref. 50048/B

Blow gun with nylon body.  
150 mm long barrel

Blister dimension: 20x20.5 cm  
Weight: 255 g  
Package: 10 pcs

See features on page 42 - COMPRESSED AIR GUNS section



**PG/S**

Ref. 50106/B

Inflating gun with nylon body

Blister dimension: 40x20.5 cm  
Weight: 510 g  
Package: 10 pcs

See features on page 48 - COMPRESSED AIR GUNS section



**PG/S CEE OM**

Ref. 50108/OB

Inflating gun to ECC standards.

Blister dimension: 40x20.5 cm  
Weight: 530 g  
Package: 10 pcs

See features on page 48 - COMPRESSED AIR GUNS section



**INFLATING HEAD**

Ref. 50129/B

2 spare inflating heads (ref.50121) for inflating guns.

Blister dimension: 7x14 cm  
Weight: 65 g  
Package: 12 pcs

See features on page 49 - COMPRESSED AIR GUNS section

**INFLATING KIT**

Ref. 50125/B

Inflating kit made of 3 special inflating heads for: bicycles, boats and balls

Blister dimension: 7x14 cm  
Weight: 65 g  
Package: 12 pcs

See features on page 49 - COMPRESSED AIR GUNS section

**N4**

(with 1000 cc aluminium cup) - Ref. 50173/B

Aluminium washing gun  
Adjustable liquid atomiser nozzle

Blister dimension: 47x20.5 cm  
Weight: 630 g  
Package: 8 pcs

See features on page 51 - COMPRESSED AIR GUNS section

**NE**

(with 1000 cc aluminium cup) - Ref. 50085/B

Aluminium washing gun with adjustable liquid atomiser

Blister dimension: 47x20.5 cm  
Weight: 630 g  
Package: 8 pcs

See features on page 93 - HOBBY LINE section

**HYDROJET**

Ref. 50160/B

Gun for mixing liquids with compressed air, manufactured in Hostaform C®

Blister dimension: 47x20.5 cm  
Weight: 440 g  
Package: 1 pcs

See features on page 51 - COMPRESSED AIR GUNS section

**SUPERMISTRAL**

Ref. 50300/B

Sandblasting gun suitable for work on small surfaces and fitted with automatic sand recovery system. Includes 4 rubber nozzles and 1 abrasive sand box of g 700.

Blister dimension: 33x47 cm  
Weight: 2.6 Kg  
Package: 1 pcs

See features on page 54 - COMPRESSED AIR GUNS section



**MISTRAL**

Ref. 50301/B

Sandblasting gun suitable for work on small surfaces, includes 1 abrasive sand box of g 700

Blister dimension: 33x47 cm

Weight: 2.4 Kg

Package: 1 pcs

See features on page 54 - COMPRESSED AIR GUNS section

**PS/E**

Ref. 50090/B

Sandblasting gun for suitable work on medium surfaces. Cemented steel nozzle.

Blister dimension: 40x20.5 cm

Weight: 650 g

Package: 6 pcs

See features on page 94 - HOBBY LINE section

**TS/E**

Ref. 50095/B

Gun for applying single component protective compounds in pre-packed 1 l tins. Supplied with 2 disposable Hostaform C® nozzle.

Blister dimension: 40x20.5 cm

Weight: 580 g

Package: 10 pcs

See features on page 94 - HOBBY LINE section

**EOLO**

Ref. 50151/B

Vacuum cleaning for cleaning inside motor vehicles.

Blister dimension: 26x40 cm

Weight: 530 g

Package: 1 pcs

See features on page 60 - COMPRESSED AIR GUNS section

**MI**

Ref. 62000/B

Air impact wrench 1/2"

Blister dimension: 24x30 cm

Weight: 2.3 Kg

Package: 1 pcs

See features on page 62 - PNEUMATIC TOOLS section

**MK**

Ref. 62005/B

Pneumatic ratchet wrench 1/2"

Blister dimension: 15x36 cm

Weight: 1.27 Kg

Package: 1 pcs

See features on page 62 - PNEUMATIC TOOLS section



**MS**

Ref. 62002/B

Air hammer

Blister dimension: 21x32 cm

Weight: 1.6 kg

Package: 1 pcs

See features on page 62 - PNEUMATIC TOOLS section

**MT**

Ref. 62004/B

Reversible air drill 3/8"

Blister dimension: 21x29 cm

Weight: 1.02 kg

Package: 1 pcs

See features on page 62 - PNEUMATIC TOOLS section

**GR/E**

Ref. 62006/B

Air grease gun

Blister dimension: 27x49 cm

Weight: 1.5 kg

Package: 1 pcs

See features on page 59 - COMPRESSED AIR GUNS section

**SET OF 4 TIPS**

Ref. 62003/B

Set of 4 tips + spring

Blister dimension: 21x29 cm

Weight: 520 g

Package: 1 pcs

See features on page 63 - PNEUMATIC TOOLS section

**SET OF SLEEVES**

Ref. 62001/B

Set of 10 hexagonal sleeves 1/2"

Blister dimension: 21x29 cm

Weight: 1.4 Kg

Package: 1 pcs

See features on page 63 - PNEUMATIC TOOLS section

**BOTTLE OF OIL**

Ref. 62008/B

Bottle of oil

Blister dimension: 11x17 cm

Weight: 132 g

Package: 1 pcs

See features on page 63 - PNEUMATIC TOOLS section





# 5 PIECES KIT IN BLISTER

## PROFESSIONAL KIT 1

Ref. 50500

Kit of 5 accessories for compressors including:

- ① - Paint spray gun mod. **UR PLUS** Ø 1.4
- ② - Washing gun mod. **NE**
- ③ - Inflating gun mod. **PG/S**
- ④ - Blow gun mod. **PA/4N**
- ⑤ - Spiral hose with fittings

## PROFESSIONAL KIT 1/CEE

Ref. 50500/O

Kit of 5 accessories same as PROFESSIONAL KIT 1 but with:

- EEC standards inflating gun mod. **PG/S CEE/OM**

Blister dimension: 45x34.5 cm

Weight: 2.170 kg

Package: 10 pcs



## PROFESSIONAL KIT 2

Ref. 50505

Kit of 5 accessories for compressors including:

- ① - Paint spray gun mod. **UR/S PLUS** Ø 1.4
- ② - Washing gun mod. **NE**
- ③ - Inflating gun mod. **PG/S**
- ④ - Blow gun mod. **PA/4N**
- ⑤ - Spiral hose with fittings

## PROFESSIONAL KIT 2/CEE

Ref. 50505/O

Kit of 5 accessories same as PROFESSIONAL KIT 2 but with:

- EEC standards inflating gun mod. **PG/S CEE/OM**

Blister dimension: 45x34.5 cm

Weight: 2.390 kg

Package: 10 pcs



## SEKUR KIT 1

Ref. 100010

Kit of 5 accessories for compressors including:

- ① - Paint spray gun mod. **PRIMA** with suction cup Ø 1.5
- ② - Washing gun mod. **NE**
- ③ - Inflating gun mod. **PG/S**
- ④ - Blow gun mod. **PA**
- ⑤ - Spiral hose with fittings

## SEKUR KIT 1/CEE

Ref. 100010/O

Kit of 5 accessories same as SEKUR KIT 1 but with:

- EEC standards inflating gun mod. **PG/S CEE/OM**

Blister dimension: 45x34.5 cm

Weight: 2.100 kg

Package: 10 pcs



## SEKUR KIT 2

Ref. 100020

Kit of 5 accessories for compressors including:

- ① - Paint spray gun mod. **PRIMA** with gravity cup Ø 1.5
- ② - Washing gun mod. **NE**
- ③ - Inflating gun mod. **PG/S**
- ④ - Blow gun mod. **PA**
- ⑤ - Spiral hose with fittings

## SEKUR KIT 2/CEE

Ref. 100020/O

Kit of 5 accessories same as SEKUR KIT 2 but with:

- EEC standards inflating gun mod. **PG/S CEE/OM**

Blister dimension: 45x34.5 cm

Weight: 2.020 kg

Package: 10 pcs



# 6 FUNCTIONS KIT IN SUITCASE

## ESA KIT

Ref. 50516

6 functions modular kit containing.

Including:

- ① - Paint spray gun mod. **PRIMA** with suction cup Ø 1.5
- ② - Spiral hose with fittings
- ③ - Blow gun mod. **PA/4N** with safety nozzle in compliance with OSHA (USA) standards

**PA/4N + OSHA nozzle** ideal to generate:

- ④ - Washing gun for naphtha
- ⑤ - Air/water gun
- ⑥ - Inflating gun

Clear suitcase: 30x35x12 cm

Weight: 2 Kg



# AIR COMPRESSED ACCESSORIES

## MICROPRESSURE REDUCER

Ref. 61000/B

Micropressure reducer

Blister dimension: 20x20.5 cm

Weight: 330 g

Package: 6 pcs

See features on page 87 - FITTINGS section



## SAFETY VALVE

Ref. 61050/B

Safety valve

Blister dimension: 7x14 cm

Weight: 100 g

Package: 12 pcs

See features on page 88 - FITTINGS section



## AIR PRESSURE SWITCH

Ref. 61060/B

Monophase 4 HP air pressure switch

Blister dimension: 20x20.5 cm

Weight: 360 g

Package: 6 pcs

See features on page 88 - FITTINGS section



## SPIRAL HOSE

Ref. 60350/B

Nylon spiral hose Ø 6x8. 5 m long with bayonet connections for milled nuts and protective spring

Blister dimension: 20x20.5 cm

Weight: 150 g

Package: 6 pcs



# AUTOMATIC COUPLINGS

## X100 S - Male

Ref.	Thread	Thread
10501/SB	I	1/4"
10502/SB	I	3/8"



Blister dimension: 7x14 cm - 2 pieces for blister - package: 12 pcs

## X300 U - Male

Ref.	Thread
10201U/B	1/4"
10202U/B	3/8"



Blister dimension: 7x14 cm - 1 piece for blister - package: 12 pcs

## X100 S - Female

Ref.	Thread	Thread
10601/SB	I	1/4"
10602/SB	I	3/8"



Blister dimension: 7x14 cm - 2 pieces for blister - package: 12 pcs

## X300 U - Female

Ref.	Thread
10211U/B	1/4"
10212U/B	3/8"



Blister dimension: 7x14 cm - 1 piece for blister - package: 12 pcs

## X100 S - For rubber hose

Ref.	Thread	Øint.-Øext.
10703/SB	I	6x14
10707/SB	I	8x17



Blister dimension: 7x14 cm - 2 pieces for blister - package: 12 pcs

## X300 U - With rest

Ref.	Ø int.
10221U/B	6
10222U/B	8



Blister dimension: 7x14 cm - 1 piece for blister - package: 12 pcs

## X100 S - For nylon hose with spring

Ref.	Standard	Øint.-Øext.
10801/SB	I	6x8
10802/SB	I	8x10



Blister dimension: 7x14 cm - 1 piece for blister - package: 12 pcs

## X300 U - For rubber hose

Ref.	Ø int.
10231U/B	6x14
10232U/B	8x17



Blister dimension: 7x14 cm - 1 piece for blister - package: 12 pcs

## X100 S - With rest

Ref.	Standard	Ø int.
10731/SB	S	6
10733/SB	S	8



Blister dimension: 7x14 cm - 2 pieces for blister - package: 12 pcs

## X300 U - For rubber hose

Ref.	Ø int.
10241U/B	6x8
10242U/B	8x10



Blister dimension: 7x14 cm - 1 piece for blister - package: 12 pcs

# STEEL FITTINGS

## Male

**FOR X100 S and X300 U**

**ONLY FOR 300 U and X300**

Ref. I	Thread	Ref. S	Thread	Ref. USA	Thread	Ref. GB	Thread	Ref. D	Thread
11001/B	1/4"	11011/B	1/4"	11021/B	1/4"	11031/B	1/4"	11041/B	1/4"
11002/B	3/8"	11012/B	3/8"	11022/B	3/8"	/	/	11042/B	3/8"



Blister dimension: 7x14 cm - 2 pieces for blister - package: 12 pcs

## Female

Ref. I	Thread	Ref. S	Thread	Ref. USA	Thread	Ref. GB	Thread	Ref. D	Thread
11101/B	1/4"	11111/B	1/4"	11121/B	1/4"	11131/B	1/4"	11141/B	1/4"
11102/B	3/8"	11112/B	3/8"	11122/B	3/8"	/	/	11142/B	3/8"



Blister dimension: 7x14 cm - 2 pieces for blister - package: 12 pcs

## For rubber hose

Ref. I	Øint.-Øext.	Ref. S	Øint.-Øext.	Ref. USA	Øint.-Øext.	Ref. GB	Øint.-Øext.	Ref. D	Øint.-Øext.
11183/B	6x14	/	/	/	/	/	/	11198/B	6x14
11187/B	8x17	/	/	/	/	/	/	11199/B	8x17



Blister dimension: 7x14 cm - 2 pieces for blister - package: 12 pcs

## Bayonet

Ref. I	Ref. S	Ref. USA	Ref. GB	Ref. D
11260/B	/	/	/	/

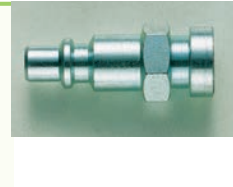

Blister dimension: 7x14 cm - 2 pieces for blister - package: 12 pcs

## For nylon hose with spring

Ref. I	Øint.-Øext.	Ref. S	Øint.-Øext.	Ref. USA	Øint.-Øext.	Ref. GB	Øint.-Øext.	Ref. D	Øint.-Øext.
11201/B	6x8	/	/	/	/	/	/	/	/
11202/B	8x10	/	/	/	/	/	/	/	/



Blister dimension: 7x14 cm - 2 pieces for blister - package: 12 pcs

## With rest

Ref. I	Ø int.	Ref. S	Ø int.	Ref. USA	Ø int.	Ref. GB	Ø int.	Ref. D	Ø int.
/	/	11301/B	6	11311/B	6	/	/	11341/B	6
/	/	11303/B	8	11313/B	8	/	/	11343/B	8

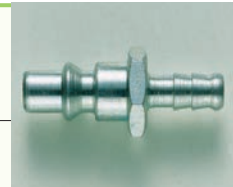

Blister dimension: 7x14 cm - 2 pieces for blister - package: 12 pcs

# FITTINGS

## Sliding cock - male

Ref.	Thread
12341/B	1/4"



Blister dimension: 7x14 cm - 1 piece for blister - package: 12 pcs

## Drain cock - maschio

Ref.	Thread
12372/B	3/8"
12373/B	1/2"



Blister dimension: 7x14 cm - 2 pieces for blister - package: 12 pcs

## Bayonet connection with rest

Ref.	Ø int. hose
13060/B	6
13062/B	8



Blister dimension: 7x14 cm - 2 pieces for blister - package: 12 pcs

## Bayonet connection male

Ref.	Thread
13011/B	1/4"



Blister dimension: 7x14 cm - 2 pieces for blister - package: 12 pcs

## Bayonet connection for rubber hose

Ref.	Ø int. - Ø ext.
13023/B	6x14
13027/B	8x17



Blister dimension: 7x14 cm - 1 piece for blister - package: 12 pcs

## Bayonet connection for nylon hose

Ref.	Ø int. - Ø ext.
13181/B	6x8



Blister dimension: 7x14 cm - 2 pieces for blister - package: 12 pcs

## Male 1/4" connection with rest for hose

Ref.	Thread	Ø int. hose
13234/B	1/4"	6
13236/B	1/4"	8



Blister dimension: 7x14 cm - 2 pieces for blister - package: 12 pcs

## Male 1/4" connection for nylon hose

Ref.	Thread	Ø int. - Ø ext.
13201/B	1/4"	6x8

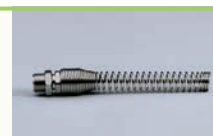

Blister dimension: 7x14 cm - 2 pieces for blister - package: 12 pcs

## Milled nut thread

Ref.	Thread
14000/B	1/4"



Blister dimension: 7x14 cm - 2 pieces for blister - package: 12 pcs

## Female 1/4" fitting with milled nut

Ref.	Thread
14010/B	1/4"



Blister dimension: 7x14 cm - 2 pieces for blister - package: 12 pcs

### Male 1/4" fitting with milled nut

Ref.	Thread
14021/B	1/4"



Blister dimension: 7x14 cm - 2 pieces for blister - package: 12 pcs

### T fitting with milled nut

Ref.	Thread
14040/B	1/4"



### Conical nipple

Ref.	Thread
14131/B	1/4" - 1/4"
14132/B	3/8" - 3/8"
14134/B	1/8" - 1/4"
14137/B	1/4" - 3/8"
14138/B	3/8" - 1/2"



Blister dimension: 7x14 cm - 2 pieces for blister - package: 12 pcs

### Extension

Ref.	Thread
14175/B	1/4" - 1/4"



Blister dimension: 7x14 cm - 2 pieces for blister - package: 12 pcs

### L fitting

Ref.	Thread
14301/B	M 1/4" - F 1/4"
14311/B	F 1/4" - F 1/4"
14316/B	M 1/4" - F 1/4"



Blister dimension: 7x14 cm - 2 pieces for blister - package: 12 pcs

### Double milled nut

Ref.	Thread
14030/B	1/4"



Blister dimension: 7x14 cm - 1 piece for blister - package: 12 pcs

### Cylindrical plug

Ref.	Thread
14251/B	1/4"



Blister dimension: 7x14 cm - 2 pieces for blister - package: 12 pcs

### Conical reduction

Ref.	Thread
14152/B	3/8" - 1/4"
14153/B	1/2" - 3/8"
14154/B	1/2" - 1/4"



Blister dimension: 7x14 cm - 2 pieces for blister - package: 12 pcs

### Double female

Ref.	Thread
14201/B	1/4" - 1/4"
14202/B	3/8" - 3/8"
14207/B	1/4" - 3/8"



Blister dimension: 7x14 cm - 2 pieces for blister - package: 12 pcs

### T fitting

Ref.	Thread
14341/B	1/4"



Blister dimension: 7x14 cm - 2 pieces for blister - package: 12 pcs

**Y fitting female/male/female**

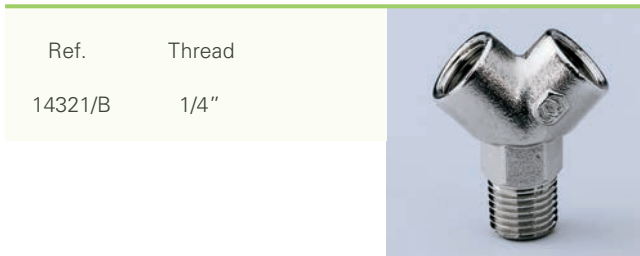

Blister dimension: 7x14 cm - 2 pieces for blister - package: 12 pcs

**Male plug "D" with milled nut**

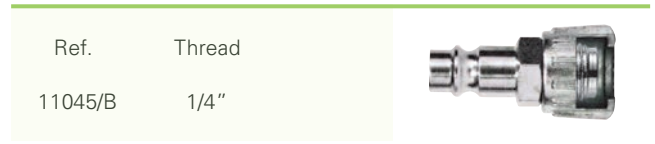

Blister dimension: 7x14 cm - 2 pieces for blister - package: 12 pcs

**Bayonet seals**



Blister dimension: 7x14 cm - 10 pieces for blister - package: 12 pcs

**Needle air line tap male with milled nut.**

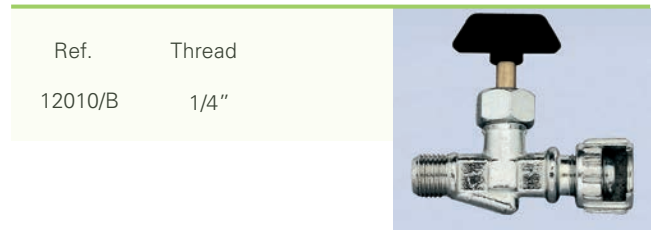

Blister dimension: 7x14 cm - 1 piece for blister - package: 12 pcs

**Mini ball valve male-male**

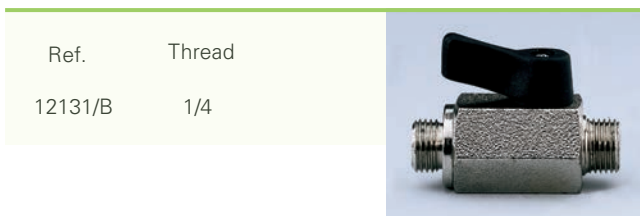

Blister dimension: 7x14 cm -1 piece for blister - package: 12 pcs

# DISPLAYS

Specifically designed to display products and keep them tidy, Walmec displays enrich the sales point, thanks to their functionality and attractive design.

From the blow guns display to the original and practical rotating shelf display for fittings.

## VENTO

Ref. 60949

Carton display containing:

- 5 PA/6 Ref. 50065
- 3 PA/6L Ref. 50066
- 1 PA/6LL Ref. 50067

Display dimension: 43x25 cm x h 41 cm  
Weight: 2.8 Kg



## JUNIOR

Display for fittings with 4 shelves containing:  
- X 100 S couplings - fittings - plugs - connections

With fittings - weight 14.5 Kg

Ref. 60930

Empty - weight 4 Kg

Ref. 60930/V

Display dimension: 35x80 cm



## MASTER

Display for fittings with 7 shelves containing:  
- X 300 U couplings - fittings - plugs - connections

With fittings - weight 31 Kg

Ref. 60931

Empty - weight 6 Kg

Ref. 60931/V

Display dimension: 35x150 cm



## PROFESSIONAL

Display for fittings with 11 shelves containing:  
- X 300 U couplings - fittings - plugs - connections  
- 12 PA/4N blow guns  
- 6 PG/S inflating guns

With fittings - weight 45.5 Kg

Ref. 60932

Empty - weight 9 Kg

Ref. 60932/V

Display dimension: 35x193 cm



## ROLLO

Ref. 60930/RR

Tidy keeper on swiveling wheels.  
Featuring: 4 coloured shelves, 4 T shape dividers  
Shelves: polypropylene  
Handle: handy grip for carrying  
Wheels: 4 swiveling wheels

Display dimension: 35x80 cm  
Weight: 4.5 Kg





## По вопросам продаж и поддержки обращайтесь:

Алматы (7273)495-231  
Ангарск (3955)60-70-56  
Архангельск (8182)63-90-72  
Астрахань (8512)99-46-04  
Барнаул (3852)73-04-60  
Белгород (4722)40-23-64  
Благовещенск (4162)22-76-07  
Брянск (4832)59-03-52  
Владивосток (423)249-28-31  
Владикавказ (8672)28-90-48  
Владимир (4922)49-43-18  
Волгоград (844)278-03-48  
Вологда (8172)26-4159  
Воронеж (473)204-51-73  
Екатеринбург (343)384-55-89  
Иваново (4932)77-34-06  
Ижевск (3412)26-03-58  
Иркутск (395)279-98-46  
Казань (843)206-01-48

Калининград (4012)72-03-81  
Калуга (4842)92-23-67  
Кемерово (3842)65-04-62  
Киров (8332)68-02-04  
Коломна (4966)23-41-49  
Кострома (4942)77-07-48  
Краснодар (861)203-40-90  
Красноярск (391)204-63-61  
Курск (4712)77-13-04  
Курган (3522)50-90-47  
Липецк (4742)52-20-81  
Магнитогорск (3519)55-03-13  
Москва (495)268-04-70  
Мурманск (8152)59-64-93  
Набережные Челны (8552)20-53-41  
Нижний Новгород (831)429-08-12  
Новокузнецк (3843)20-46-81  
Ноябрьск (3496)41-32-12  
Новосибирск (383)227-86-73

Омск (3812)21-46-40  
Орел (4862)44-53-42  
Оренбург (3532)37-68-04  
Пенза (8412)22-31-16  
Петрозаводск (8142)55-98-37  
Псков (8112)59-10-37  
Пермь (342)205-81-47  
Ростов-на-Дону (863)308-18-15  
Рязань (4912)46-61-64  
Самара (846)206-03-16  
Саранск (8342)22-96-24  
Санкт-Петербург (812)309-46-40  
Саратов (845)249-38-78  
Севастополь (8692)22-31-93  
Симферополь (3652)67-13-56  
Смоленск (4812)29-41-54  
Сочи (862)225-72-31  
Ставрополь (8652)20-65-13  
Сургут (3462)77-98-35

Сыктывкар (8212)25-95-17  
Тамбов (4752)50-40-97  
Тверь (4822)63-31-35  
Тольятти (8482)63-91-07  
Томск (3822)98-41-53  
Тула (4872)33-79-87  
Тюмень (3452)66-21-18  
Ульяновск (8422)24-23-59  
Улан-Удэ (3012)59-97-51  
Уфа (347)229-48-12  
Хабаровск (4212)92-98-04  
Чебоксары (8352)28-53-07  
Челябинск (351)202-03-61  
Череповец (8202)49-02-64  
Чита (3022)38-34-83  
Якутск (4112)23-90-97  
Ярославль (4852)69-52-93

Россия +7(495)268-04-70

Казахстан +7(7172)727-132

Киргизия +996(312)96-26-47

Адрес: <https://walmec.nt-rt.ru/> || эл. почта: [wce@nt-rt.ru](mailto:wce@nt-rt.ru)